

Plotted By: Burns, Thomas Date: August 12, 2024 06:10:23pm File Path: \\kimley-horn.com\IS_SAU_SAU_LALP_063895123_Round Rock OSP_Build-Out_Tennis_Pickleball\Draw_Sheets\L-5_Site_Plan.dwg
 This document, together with the concepts and designs presented herein, is intended only for the specific purpose and client for which it was prepared. Reuse of and improper reliance on this document without written authorization and adaptation by Kimley-Horn and Associates, Inc. shall be without liability to Kimley-Horn and Associates, Inc.

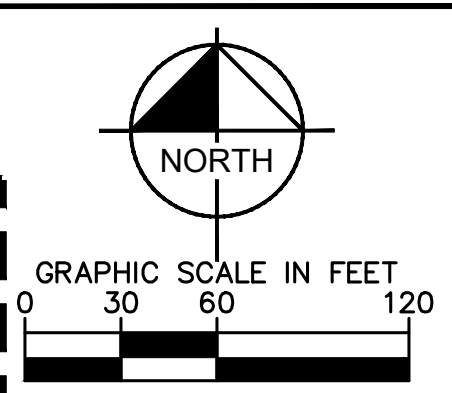
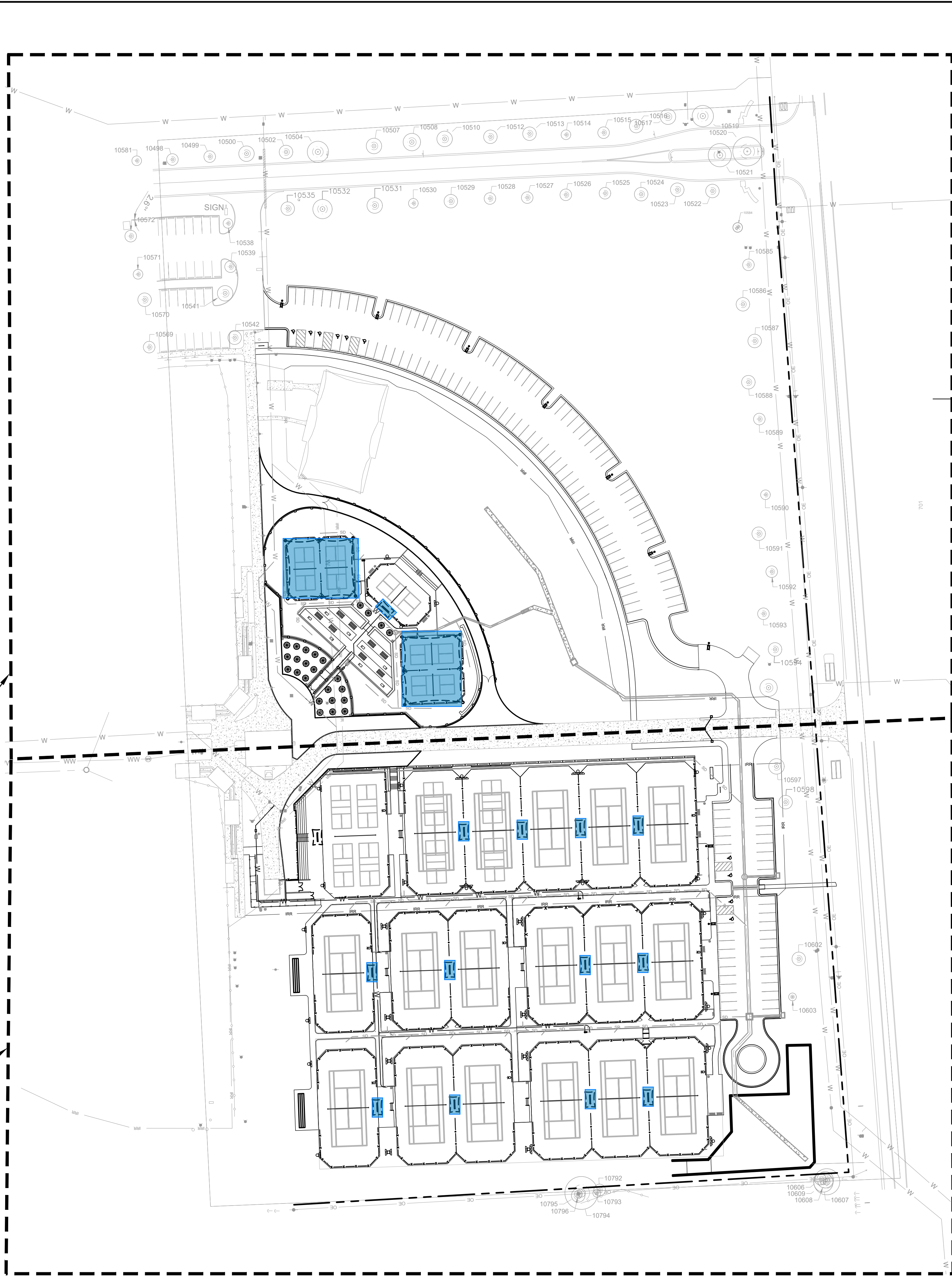
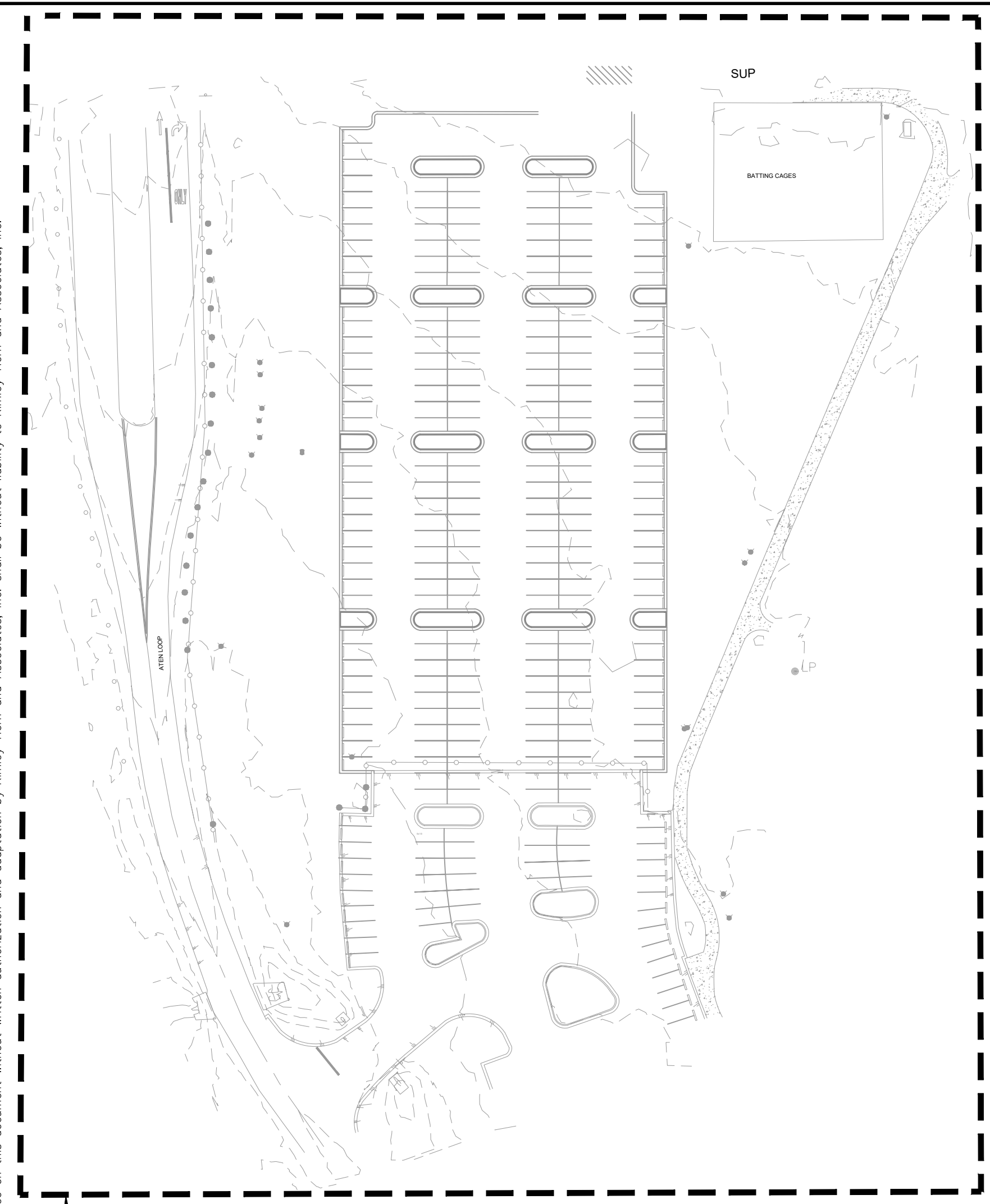

SHEET L-4.0 JOINTING PLAN AND DETAIL KEY
 SHEET L-6.0 LANDSCAPE PLAN
 SHEET L-8.0 IRRIGATION PLAN
 SHEET C1.0 PAVNG PLAN
 SHEET C2.0 GRADING AND DRAINAGE PLAN
 SHEET C3.0 EROSION CONTROL PLAN
 SHEET C5.0 DETENTION PLAN
 SHEET C6.0 UTILITY PLAN

SHEET C11.0 PAVING AND STRIPING PLAN
 SHEET C12.0 DIMENSION CONTROL PLAN
 SHEET C13.0 GRADING PLAN
 SHEET C13.0 EROSION CONTROL PLAN

SHEET L-4.1 JOINTING PLAN AND DETAIL KEY
 SHEET L-6.1 LANDSCAPE PLAN
 SHEET L-8.1 IRRIGATION PLAN
 SHEET C1.1 PAVNG PLAN
 SHEET C2.1 GRADING AND DRAINAGE PLAN
 SHEET C3.1 EROSION CONTROL PLAN
 SHEET C5.1 DETENTION PLAN
 SHEET C6.1 UTILITY PLAN

1 KEY SHEET
 SCALE: 1"=60'



| No. | REVISIONS | DATE | BY |
|-----|-----------|------|----|
| | | | |

Kimley-Horn
 © 2024 KIMLEY-HORN AND ASSOCIATES, INC.
 5301 SOUTHWEST PARKWAY BUILDING 2, SUITE 100, AUSTIN, TX 78735
 PHONE: 512-418-1771 FAX: 512-418-1791
 WWW.KIMLEY-HORN.COM
 TEXAS REGISTERED ENGINEERING FIRM F-928

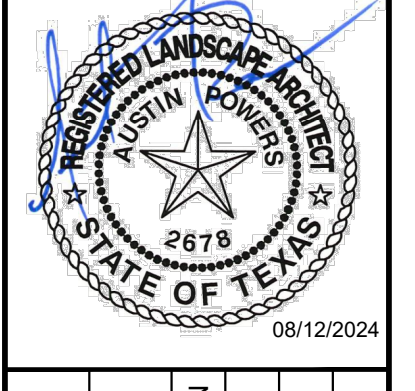

| | |
|-------------|-------------|
| KHA PROJECT | 063895123 |
| DATE | AUGUST 2024 |
| SCALE | AS SHOWN |
| DESIGNED BY | RK |
| DRAWN BY | AB |
| CHECKED BY | AP |

KEY SHEET

**OLD SETTLER'S PARK
 TENNIS AND
 PICKLEBALL COURTS**
 CITY OF ROUND ROCK, TEXAS

SHEET NUMBER
L-0.1