

EXHIBIT

“A”

AGREEMENT WITH CITY OF ROUND ROCK, TEXAS AND WILLIAMSON COUNTY REGARDING RELOCATION OF 10” CITY WASTEWATER ALONG HAIRY MAN ROAD

This Agreement (“Agreement”) is entered into by and between the City of Round Rock, Texas. (“City”), a Texas political subdivision and Williamson County, Texas (“County”), a Texas political subdivision.

RECITALS

WHEREAS, a 10” wastewater pipeline (the “Pipeline”) is currently located within the right-of-way of Hairy Man Road in Williamson County, Texas; and

WHEREAS, County is currently advertising the construction of improvements to Hairy Man Road (the “County Project”); and

WHEREAS, the parties desire to incorporate into the Project the construction to relocate approximately 130 linear feet of the Pipeline (the “Relocation Project”); and

WHEREAS, as the design of the Relocation Project was approved by the City, the County will incorporate the Relocation Project as a separate bid item in the County Project; and

WHEREAS, the parties desire to share costs for the Relocation Project as described herein.

NOW, THEREFORE, in consideration of the foregoing premises and the mutual covenants and agreements herein contained, City and County agree as follows:

- 1. Relocation Project.** This Agreement addresses the Relocation of approximately 130 linear feet of a 10” wastewater line including 50 linear feet of jacking and boring of a 20” steel encasement, and installation of required appurtenances associated with the Pipeline relocation. The plans including location of the Relocation Project is attached hereto as Exhibit “A”.
- 2. Construction.** The County will construct the Relocation Project in conjunction with the County Project and in conformity with the CobbFendley design approved by the City. The City will conduct inspections of the Relocation Project during construction and after acceptance of the Relocation Project, the City will resume responsibility for operation and maintenance of the Pipeline.

3. Payment and Costs.

- a. The initial cost estimate for construction of the Relocation Project is expected to be approximately \$44,232.50 (the "Construction Costs"). The City agrees to be responsible for the Construction Costs of the Relocation Project after the Relocation Project is completed by the County and approved by the City. The engineer's opinion of probable cost is attached hereto as Exhibit "B".
- b. Any changes to any segment or phase of the Relocation Project may affect costs. City agrees to pay any additional costs resulting from any changes to the Relocation Project, if approved in advance, in writing, by the City.

4. Communication. City and County agree to hold periodic project status information meetings. County's official point of contact for the Relocation Project is Terron Evertson, County Engineer. City's official point of contact is Jeff Bell, Sr. Project Manager, City of Round Rock. City and County agree to include these designated points of contact in the chain of communication for all significant decisions and recommendations prepared by design engineers and other parties and representatives.

5. Schedule. Design and construction of the Relocation Project is expected to take approximately 24 months. The parties acknowledge that the timeframe is estimated and is subject to force majeure.

6. Liability; No Waiver of Immunities.

- a. City does not assume any liability for any property damage, injuries or death in connection with the design, engineering or construction of the Relocation Project. TO THE EXTENT PERMITTED BY LAW, COUNTY HEREBY AGREES TO INDEMNIFY, DEFEND AND HOLD CITY AND ITS DIRECTORS, OFFICERS, EMPLOYEES AND AGENTS HARMLESS FROM AND AGAINST ANY AND ALL LOSS, LIABILITY, CLAIM, DAMAGE, COST OR EXPENSE (INCLUDING REASONABLE LEGAL FEES AND EXPENSES) ARISING OUT OF OR IN CONNECTION WITH THE DESIGN, ENGINEERING OR CONSTRUCTION OF THE RELOCATION PROJECT.
- b. Nothing in this Agreement shall be deemed to waive, modify or alter to any extent any defense or immunity available at law or in equity to City or County, or their past or present officers, employees, or agents, nor to create any legal rights or claim on behalf of any non-party.

7. Term. The term of this Agreement is for a period of three (3) years from the Effective Date unless otherwise earlier terminated by the parties.

- 8. Entire Agreement.** This Agreement represents and contains the entire agreement and understanding between the parties with respect to the subject matter herein and supersedes any and all prior or contemporaneous oral and/or written agreements and understandings.
- 9. Governing Law.** This Agreement shall be construed and enforced in accordance with Texas law. The Parties acknowledge that Subchapter 1, Chapter 271 of the Texas Local Government Code is a legislative waiver of any sovereign immunity with the County to this Agreement, and each party waives immunity to suit for the purpose of adjudicating any claims under this Agreement. Venue for the litigation of any dispute arising hereunder shall be in Williamson County, Texas.
- 10. Counterparts.** This Agreement may be executed in any number of counterparts, and it will not be necessary.
- 11. No Joint Venture.** It is acknowledged and agreed by the parties that the terms herein are not intended to and shall not be deemed to create any partnership or joint venture among the parties. The City, its employees, elected officials and agents, do not assume any responsibilities or liabilities to any third party in connection with the Relocation Project.

Executed to be effective this ____ day of _____, 2020 (the "Effective Date").

(SIGNATURES ON FOLLOWING PAGES)

WILLIAMSON COUNTY

By: _____

William Gravell, Jr., County Judge

Date: _____

Attest:

Nancy Rister, County Clerk

ROUND ROCK, TEXAS

By: _____
Craig Morgan, Mayor

Date: _____

Attest:

Sara White, City Clerk

EXHIBIT A

Plans of the Relocation Project

**EXHIBIT
"A"**



**WILLIAMSON COUNTY
HAIRY MAN RD./BRUSHY CREEK RD. IMPROVEMENTS
ROUND ROCK 10 INCH WWL RELOCATION**

TOTAL LENGTH OF PROJECT: 130 LF
PROJECT LIMITS: 95 FT EAST OF HAIRY MAN RD./CREEK BEND BLVD. INTERSECTION, CROSSING HAIRY MAN RD.

RELOCATION OF 10" WASTEWATER LINE, INCLUDING OPEN CUT, INSTALLATION OF ASSOCIATED
APPURTENANCES, AND RECONNECTION TO EXISTING MAIN

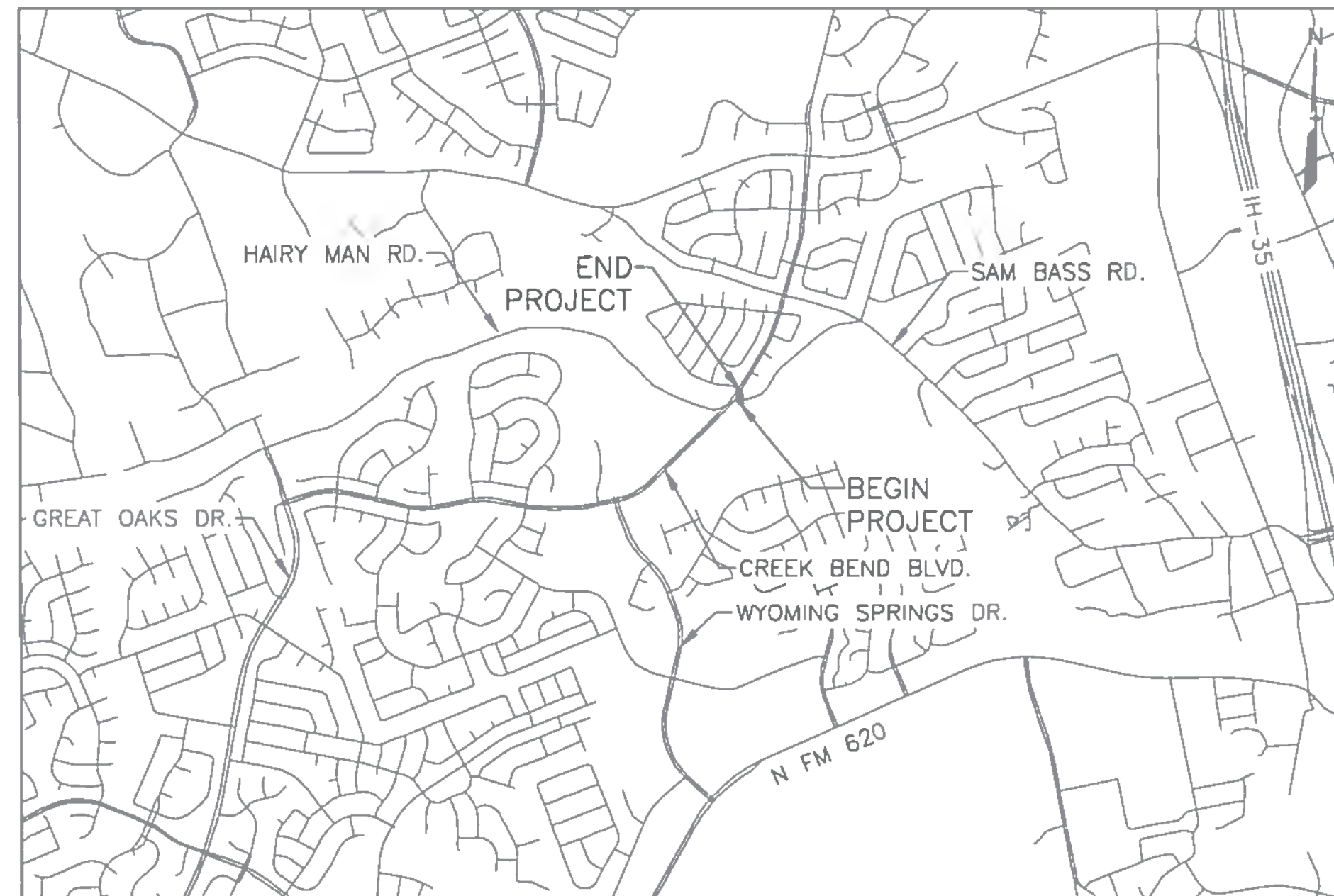

VICINITY MAP
(NOT TO SCALE)

INDEX OF SHEETS

C-001	TITLE SHEET
C-002	GENERAL NOTES AND SUMMARY OF QUANTITIES
C-100	KEY MAP
C-101	PROP. 10" WWL PLAN AND PROFILE STA. 10+00 TO END
C-102	EROSION CONTROL SHEET
C-501	STANDARD DETAILS - SHEET 1
C-502	STANDARD DETAILS - SHEET 2

OWNER INFORMATION

OWNER:
CITY OF ROUND ROCK, TEXAS
2008 ENTERPRISE DRIVE
ROUND ROCK, TEXAS 78664

CONTACT:
JEFF BELL
SENIOR PROJECT MANAGER
512-218-7076

DESIGNER:
COBB FENDLEY
505 E. HUNTLAND DR. SUITE 100
AUSTIN, TEXAS 78752

CONTACT:
STANLEY FEES, P.E.
512-834-9798

100% SUBMITTAL

SUBMITTED FOR REVIEW

 OCTOBER 24, 2019
 DATE
 STANLEY FEES, P.E.
 COBB FENDLEY, INC.

APPROVALS:

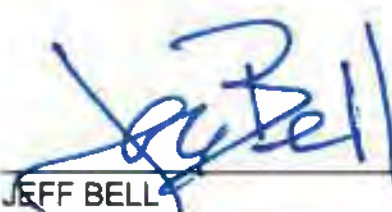
 3.6.20
 DATE
 JEFF BELL
 CITY OF ROUND ROCK, TEXAS

REV. NO.	REVISION DESCRIPTION	(CORRECT, ADD, VOID) SHEET NUMBERS	APPR'D BY	DATE

Exhibit A

CobbFendley

TBPE NO 274 / TBPLS NO 10046701
 505 EAST HUNTLAND DRIVE SUITE 100
 AUSTIN, TEXAS 78752
 512 834 9798 | FAX 512.834.7277
 WWW.COBBFENDLEY.COM

Dwg Info \\vaustinsvr\csm\2014\0308501-williamson-county-2013-road-bond\WMA\07-hairy-man-brushy-creek-road\DESIGN\C-001-COVER.dwg Tab: C001_COVER Plotted: 10/24/2019 4:42 PM By: ARGA_MAST

GENERAL NOTES

- ALL CONSTRUCTION SHALL BE IN ACCORDANCE WITH THE CITY OF ROUND ROCK STANDARD SPECIFICATIONS MANUAL.
- ANY EXISTING UTILITIES, PAVEMENT, CURBS, SIDEWALKS, STRUCTURES, TREES, ETC., NOT PLANNED FOR DESTRUCTION OR REMOVAL THAT ARE DAMAGED OR REMOVED SHALL BE REPAIRED OR REPLACED AT HIS EXPENSE.
- THE CONTRACTOR SHALL VERIFY ALL DEPTHS AND LOCATIONS OF EXISTING UTILITIES PRIOR TO ANY CONSTRUCTION. ANY DISCREPANCIES WITH THE CONSTRUCTION PLANS FOUND IN THE FIELD SHALL BE BROUGHT IMMEDIATELY TO THE ATTENTION OF THE ENGINEER WHO SHALL BE RESPONSIBLE FOR REVISING THE PLANS ARE APPROPRIATE.
- MANHOLE FRAMES, COVERS, VALVES, CLEANOUTS, ETC. SHALL BE RAISED TO FINISHED GRADE PRIOR TO FINAL PAVING CONSTRUCTION.
- THE CONTRACTOR SHALL GIVE THE CITY OF ROUND ROCK INSPECTOR AND CONSTRUCTION OBSERVER 48 HOURS NOTICE BEFORE BEGINNING EACH PHASE OF CONSTRUCTION.
- ALL AREAS DISTURBED OR EXPOSED DURING CONSTRUCTION SHALL BE REVEGETATED IN ACCORDANCE WITH THE PLANS AND SPECIFICATIONS. REVEGETATION OF ALL DISTURBED OR EXPOSED AREAS SHALL CONSIST OF SODDING OR SEEDING, AT THE CONTRACTOR'S OPTION. HOWEVER, THE TYPE OF REVEGETATION MUST EQUAL OR EXCEED THE TYPE OF VEGETATION PRESENT BEFORE CONSTRUCTION. REVEGETATION SHALL BE INCLUDED IN THE MAIN ROADWAY PLANS.
- PRIOR TO ANY CONSTRUCTION, THE ENGINEER SHALL CONVENE A PRECONSTRUCTION CONFERENCE BETWEEN THE CITY OF ROUND ROCK, HIMSELF, THE CONTRACTOR, OTHER UTILITY COMPANIES, THE COUNTY OBSERVER, ANY AFFECTED PARTIES AND ANY OTHER ENTITY THE CITY OR ENGINEER MAY REQUIRE.
- THE CONTRACTOR AND THE ENGINEER SHALL KEEP ACCURATE RECORDS OF ALL CONSTRUCTION THAT DEVIATES FROM THE PLANS. THE ENGINEER SHALL FURNISH THE CITY OF ROUND ROCK ACCURATE "AS-BUILT" DRAWINGS FOLLOWING COMPLETION OF ALL CONSTRUCTION. THESE "ASBUILT" DRAWINGS SHALL MEET WITH THE SATISFACTION OF THE ENGINEERING AND DEVELOPMENT SERVICES DEPARTMENT PRIOR TO FINAL ACCEPTANCE.
- THE ROUND ROCK CITY COUNCIL SHALL NOT BE PETITIONED FOR ACCEPTANCE UNTIL ALL NECESSARY EASEMENT DOCUMENTS HAVE BEEN SIGNED AND RECORDED.
- WHEN CONSTRUCTION IS BEING CARRIED OUT WITHIN EASEMENTS, THE CONTRACTOR SHALL CONFINE HIS WORK TO WITHIN THE PERMANENT AND ANY TEMPORARY EASEMENTS. PRIOR TO FINAL ACCEPTANCE, THE CONTRACTOR SHALL BE RESPONSIBLE FOR REMOVING ALL TRASH AND DEBRIS WITHIN THE PERMANENT AND TEMPORARY EASEMENTS. CLEAN-UP SHALL BE TO THE SATISFACTION OF THE CITY ENGINEER.
- PRIOR TO ANY CONSTRUCTION, THE CONTRACTOR SHALL APPLY FOR AND SECURE ALL PROPER PERMITS FROM THE APPROPRIATE AUTHORITIES.

TRENCH SAFETY

- IN ACCORDANCE WITH THE LAWS OF THE STATE OF TEXAS AND THE U. S. OCCUPATIONAL SAFETY AND HEALTH ADMINISTRATION REGULATIONS, ALL TRENCHES OVER 5 FEET IN DEPTH IN EITHER HARD AND COMPACT OR SOFT AND UNSTABLE SOIL SHALL BE SLOPED, SHORED, SHEETED, BRACED OR OTHERWISE SUPPORTED. FURTHERMORE, ALL TRENCHES LESS THAN 5 FEET IN DEPTH SHALL ALSO BE EFFECTIVELY PROTECTED WHEN HAZARDOUS GROUND MOVEMENT MAY BE EXPECTED. TRENCH SAFETY SYSTEMS TO BE UTILIZED FOR EACH PROJECT WILL BE PROVIDED TO CONTRACTOR.
- IN ACCORDANCE WITH THE U. S. OCCUPATIONAL SAFETY AND HEALTH ADMINISTRATION REGULATIONS, WHEN PERSONS ARE IN TRENCHES 4 FEET DEEP OR MORE, ADEQUATE MEANS OF EXIT, SUCH AS A LADDER OR STEPS, MUST BE PROVIDED AND LOCATED SO AS TO REQUIRE NO MORE THAN 25 FEET OF LATERAL TRAVEL.
- IF TRENCH SAFETY SYSTEM DETAILS WERE NOT PROVIDED IN THE PLANS BECAUSE TRENCHES WERE ANTICIPATED TO BE LESS THAN 5 FEET IN DEPTH AND DURING CONSTRUCTION IT IS FOUND THAT TRENCHES ARE IN FACT 5 FEET OR MORE IN DEPTH OR TRENCHES LESS THAN 5 FEET IN DEPTH ARE IN AN AREA WHERE HAZARDOUS GROUND MOVEMENT IS EXPECTED, ALL CONSTRUCTION SHALL CEASE, THE TRENCHED AREA SHALL BE BARRICADED AND THE ENGINEER NOTIFIED IMMEDIATELY. CONSTRUCTION SHALL NOT RESUME UNTIL APPROPRIATE TRENCH SAFETY SYSTEM DETAILS, AS DESIGNED BY A PROFESSIONAL ENGINEER, ARE RETAINED AND COPIES SUBMITTED TO THE CITY OF ROUND ROCK.

STREET AND DRAINAGE

- ALL TESTING SHALL BE DONE BY AN INDEPENDENT LABORATORY AT THE OWNER'S EXPENSE. ANY RETESTING SHALL BE PAID FOR BY THE CONTRACTOR. A CITY INSPECTOR SHALL BE PRESENT DURING ALL TESTS. TESTING SHALL BE COORDINATED WITH THE CITY INSPECTOR AND HE SHALL BE GIVEN A MINIMUM OF 24 HOURS NOTICE PRIOR TO ANY TESTING. TELEPHONE 218-5555 (INSPECTIONS).
- BACKFILL BEHIND THE CURB SHALL BE COMPACTED TO OBTAIN A MINIMUM OF 95% MAXIMUM DENSITY TO WITHIN 3" OF TOP OF CURB. MATERIAL USED SHALL BE PRIMARILY GRANULAR WITH NO ROCKS LARGER THAN 6" IN THE GREATEST DIMENSION. THE REMAINING 3" SHALL BE CLEAN TOPSOIL FREE FROM ALL CLODS AND SUITABLE FOR SUSTAINING PLANT LIFE.
- DEPTH OF COVER FOR ALL CROSSINGS UNDER PAVEMENT INCLUDING GAS, ELECTRIC, TELEPHONE, CABLE TV, WATER SERVICES, ETC., SHALL BE A MINIMUM OF 30" BELOW SUBGRADE.

WATER AND WASTEWATER

- PIPE MATERIAL FOR WATER MAINS SHALL BE PVC (AWWA C-900, MIN. CLASS 200), OR DUCTILE IRON (AWWA C-100, MIN. CLASS 200). WATER SERVICES (2" OR LESS) SHALL BE POLYETHYLENE TUBING (BLACK, 200 PSI, DR 9).
- PIPE MATERIAL FOR PRESSURE WASTEWATER MAINS SHALL BE PVC (AWWA C-900, MIN. CLASS 150), OR DUCTILE IRON (AWWA C-100, MIN. CLASS 200). PIPE MATERIAL FOR GRAVITY WASTEWATER MAINS SHALL BE PVC (ASTM D2241 OR D3034, MAX. DR=26), DUCTILE IRON (AWWA C-100, MIN. CLASS 200).
- UNLESS OTHERWISE ACCEPTED BY THE CITY ENGINEER, DEPTH OF COVER FOR ALL LINES OUT OF THE PAVEMENT SHALL BE 42" MIN., AND DEPTH OF COVER FOR ALL LINES UNDER PAVEMENT SHALL BE A MIN. OF 30" BELOW SUBGRADE.
- ALL FIRE HYDRANT LEADS SHALL BE DUCTILE IRON PIPE (AWWA C-100, MIN. CLASS 200).
- ALL IRON PIPE AND FITTINGS SHALL BE WRAPPED WITH MINIMUM 8-MIL POLYETHYLENE AND SEALED WITH DUCT TAPE OR EQUAL ACCEPTED BY THE CITY ENGINEER.
- THE CONTRACTOR SHALL CONTACT THE CITY INSPECTOR AT 218-5555 TO COORDINATE UTILITY TIE-INS AND NOTIFY HIM AT LEAST 48 HOURS PRIOR TO CONNECTING TO EXISTING LINES.

- ALL MANHOLES SHALL BE CONCRETE WITH CAST IRON RING AND COVER. ALL MANHOLES LOCATED OUTSIDE OF THE PAVEMENT SHALL HAVE BOLTED COVERS. TAPPING OF FIBERGLASS MANHOLES SHALL NOT BE ALLOWED.
- THE CONTRACTOR MUST OBTAIN A BULK WATER PERMIT OR PURCHASE AND INSTALL A WATER METER FOR ALL WATER USED DURING CONSTRUCTION. A COPY OF THIS PERMIT MUST BE CARRIED AT ALL TIMES BY ALL WHO USE WATER.
- LINE FLUSHING OR ANY ACTIVITY USING A LARGE QUANTITY OF WATER MUST BE SCHEDULED WITH INSPECTOR.
- THE CONTRACTOR, AT HIS EXPENSE, SHALL PERFORM STERILIZATION OF ALL POTABLE WATER LINES CONSTRUCTED AND SHALL PROVIDE ALL EQUIPMENT (INCLUDING TEST GAUGES), SUPPLIES (INCLUDING CONCENTRATED CHLORINE DISINFECTING MATERIAL), AND NECESSARY LABOR REQUIRED FOR THE STERILIZATION PROCEDURE. THE STERILIZATION PROCEDURE SHALL BE MONITORED BY CITY OF ROUND ROCK PERSONNEL. WATER SAMPLES WILL BE COLLECTED BY THE CITY OF ROUND ROCK TO VERIFY EACH TREATED LINE HAS ATTAINED AN INITIAL CHLORINE CONCENTRATION OF 50 PPM. WHERE MEANS OF FLUSHING IS NECESSARY, THE CONTRACTOR, AT HIS EXPENSE, SHALL PROVIDE FLUSHING DEVICES AND REMOVE SAID DEVICES PRIOR TO FINAL ACCEPTANCE BY THE CITY OF ROUND ROCK.
- SAMPLING TAPS SHALL BE BROUGHT UP TO 3 FEET ABOVE GRADE AND SHALL BE EASILY ACCESSIBLE FOR CITY PERSONNEL. AT THE CONTRACTOR'S REQUEST, AND IN HIS PRESENCE, SAMPLES FOR BACTERIOLOGICAL TESTING WILL BE COLLECTED BY THE CITY OF ROUND ROCK NOT LESS THAN 24 HOURS AFTER THE TREATED LINE HAS BEEN FLUSHED OF THE CONCENTRATED CHLORINE SOLUTION AND CHARGED WITH WATER APPROVED BY THE CITY. CONTRACTOR WILL BE RESPONSIBLE FOR THE COST OF THE PRE-TESTING DUE TO FAILED TEST.
- THE CONTRACTOR, AT HIS EXPENSE, SHALL PERFORM QUALITY TESTING FOR ALL WASTEWATER PIPE INSTALLED AND PRESSURE PIPE HYDROSTATIC TESTING OF ALL WATER LINES CONSTRUCTED AND SHALL PROVIDE ALL EQUIPMENT (INCLUDING PUMPS AND GAUGES), SUPPLIES AND LABOR NECESSARY TO PERFORM THE TESTS. QUALITY AND PRESSURE TESTING SHALL BE MONITORED BY CITY OF ROUND ROCK PERSONNEL.
- THE CONTRACTOR SHALL COORDINATE TESTING WITH THE CITY OF INSPECTOR AND PROVIDE NO LESS THAN 24 HOURS NOTICE PRIOR TO PERFORMING STERILIZATION, QUALITY TESTING OR PRESSURE TESTING.
- THE CONTRACTOR SHALL NOT OPEN OR CLOSE ANY VALVES UNLESS AUTHORIZED BY THE CITY OF ROUND ROCK.
- ALL VALVE BOXES AND COVERS SHALL BE CAST IRON.
- ALL WATER SERVICE, WASTEWATER SERVICE AND VALVE LOCATIONS SHALL BE APPROPRIATELY MARKED AS FOLLOWS:

WATER SERVICE "W" ON TOP OF CURB
WASTEWATER SERVICE "S" ON TOP OF CURB
VALVE "V" ON FACE OF CURB

- TOOLS FOR MARKING THE CURB SHALL BE PROVIDED BY THE CONTRACTOR. OTHER APPROPRIATE MEANS OF MARKING SERVICE AND VALVE LOCATIONS SHALL BE PROVIDED IN AREAS WITHOUT CURBS. SUCH MEANS OF MARKING SHALL BE AS SPECIFIED BY THE ENGINEER AND ACCEPTED BY THE CITY OF ROUND ROCK.
- CONTACT CITY OF ROUND ROCK ENGINEERING AND DEVELOPMENT SERVICES DEPARTMENT FOR ASSISTANCE IN OBTAINING EXISTING WATER AND WASTEWATER LOCATIONS.
- THE CITY OF ROUND ROCK FIRE DEPARTMENT SHALL BE NOTIFIED 48 HOURS PRIOR TO TESTING OF ANY BUILDING SPRINKLER PIPING IN ORDER THAT THE FIRE DEPARTMENT MAY MONITOR SUCH TESTING.
- SAND, AS DESCRIBED IN SPECIFICATION ITEM 510 PIPE, SHALL NOT BE USED AS BEDDING FOR WATER AND WASTEWATER LINES. ACCEPTABLE BEDDING MATERIALS ARE PIPE BEDDING STONE, PEA GRAVEL AND IN LIEU OF SAND, A NATURALLY OCCURRING OR MANUFACTURED STONE MATERIAL CONFORMING TO ASTM C33 FOR STONE QUALITY AND MEETING THE FOLLOWING GRADATION SPECIFICATION:

SIEVE SIZE	PERCENT RETAINED BY WEIGHT
1/2"	0
3/8"	0-2
#4	40-85
#10	95-100

- THE CONTRACTOR IS HEREBY NOTIFIED THAT CONNECTING TO, SHUTTING DOWN, OR TERMINATING EXISTING UTILITY LINES MAY HAVE TO OCCUR AT OFF-PEAK HOURS. SUCH HOURS ARE USUALLY OUTSIDE NORMAL WORKING HOURS AND POSSIBLY BETWEEN 12 A.M. AND 6 A.M.
- ALL WASTEWATER CONSTRUCTION SHALL BE IN ACCORDANCE WITH THE TEXAS COMMISSION ON ENVIRONMENTAL QUALITY (TCEQ) REGULATIONS, 30 TAC CHAPTER 213 AND 317, AS APPLICABLE. WHENEVER TCEQ AND CITY OF ROUND ROCK SPECIFICATIONS CONFLICT, THE MORE STRINGENT SHALL APPLY.

TEXAS COMMISSION ON ENVIRONMENTAL QUALITY CONTRIBUTING ZONE PLAN GENERAL CONSTRUCTION NOTES

- A WRITTEN NOTICE OF CONSTRUCTION MUST BE SUBMITTED TO THE TCEQ REGIONAL OFFICE AT LEAST 48 HOURS PRIOR TO THE START OF ANY GROUND DISTURBANCE OR CONSTRUCTION ACTIVITIES. THIS NOTICE MUST INCLUDE:
 THE NAME OF THE APPROVED PROJECT
 THE ACTIVITY START DATE; AND
 THE CONTACT INFORMATION OF THE PRIME CONTRACTOR
- ALL CONTRACTORS CONDUCTING REGULATED ACTIVITIES ASSOCIATED WITH THIS PROJECT SHOULD BE PROVIDED WITH COMPLETE COPIES OF THE APPROVED CONTRIBUTING ZONE PLAN (CZP) AND THE TCEQ LETTER INDICATING THE SPECIFIC CONDITIONS OF ITS APPROVAL. DURING THE COURSE OF THESE REGULATED ACTIVITIES, THE CONTRACTOR(S) SHOULD KEEP COPIES OF THE APPROVED PLAN AND APPROVAL LETTER ON-SITE.
- NO HAZARDOUS SUBSTANCE STORAGE TANK SHALL BE INSTALLED WITHIN 150 FEET OF A WATER SUPPLY SOURCE, DISTRIBUTION SYSTEM, WELL, OR SENSITIVE FEATURE.
- PRIOR TO BEGINNING ANY CONSTRUCTION ACTIVITY, ALL TEMPORARY EROSION AND SEDIMENTATION (E&S) CONTROL MEASURES MUST BE PROPERLY INSTALLED AND MAINTAINED IN ACCORDANCE WITH THE MANUFACTURERS SPECIFICATIONS. IF INSPECTIONS INDICATE A CONTROL HAS BEEN USED INAPPROPRIATELY, OR INCORRECTLY, THE APPLICANT MUST REPLACE OR MODIFY THE CONTROL FOR SITE SITUATIONS. THESE CONTROLS MUST REMAIN IN PLACE UNTIL THE DISTURBED AREAS HAVE BEEN PERMANENTLY STABILIZED.
- ANY SEDIMENT THAT ESCAPES THE CONSTRUCTION SITE MUST BE COLLECTED AND PROPERLY DISPOSED OF BEFORE THE NEXT RAIN EVENT TO ENSURE IT IS NOT WASHED INTO SURFACE

STREAMS, SENSITIVE FEATURES, ETC.

- SEDIMENT MUST BE REMOVED FROM THE SEDIMENT TRAPS OR SEDIMENTATION BASINS WHEN IT OCCUPIES 50% OF THE BASIN'S DESIGN CAPACITY.
- LITTER, CONSTRUCTION DEBRIS, AND CONSTRUCTION CHEMICALS EXPOSED TO STORMWATER SHALL BE PREVENTED FROM BEING DISCHARGED OFFSITE.
- ALL EXCAVATED MATERIAL THAT WILL BE STORED ON-SITE MUST HAVE PROPER E&S CONTROLS.
- IF PORTIONS OF THE SITE WILL HAVE A CEASE IN CONSTRUCTION ACTIVITY LASTING LONGER THAN 14 DAYS, SOIL STABILIZATION IN THOSE AREAS SHALL BE INITIATED AS SOON AS POSSIBLE PRIOR TO THE 14TH DAY OF INACTIVITY. IF ACTIVITY WILL RESUME PRIOR TO THE 21ST DAY, STABILIZATION MEASURES SHALL BE INITIATED AS SOON AS POSSIBLE.
- THE FOLLOWING RECORDS SHOULD BE MAINTAINED AND MADE AVAILABLE TO THE TCEQ UPON REQUEST:
 THE DATES WHEN MAJOR GRADING ACTIVITIES OCCUR
 THE DATES WHEN CONSTRUCTION ACTIVITIES TEMPORARILY OR PERMANENTLY CEASE ON A PORTION OF THE SITE; AND THE DATES WHEN STABILIZATION MEASURES ARE INITIATED.
- THE HOLDER OF ANY APPROVED CZP MUST NOTIFY THE APPROPRIATE REGIONAL OFFICE IN WRITING AND OBTAIN APPROVAL FROM THE EXECUTIVE DIRECTOR PRIOR TO INITIATING ANY OF THE FOLLOWING:
 ANY PHYSICAL OR OPERATIONAL MODIFICATION OF ANY BEST MANAGEMENT PRACTICES (BMPs) OR STRUCTURE(S), INCLUDING BUT NOT LIMITED TO TEMPORARY OR PERMANENT PONDS, DAMS, BERMS, SILT FENCES, AND DIVERSIONARY STRUCTURES;
 ANY CHANGE IN THE NATURE OR CHARACTER OF THE REGULATED ACTIVITY FROM THAT WHICH WAS ORIGINALLY APPROVED;
 ANY CHANGE THAT WOULD SIGNIFICANTLY IMPACT THE ABILITY TO PREVENT POLLUTION OF THE EDWARDS AQUIFER; OR
 ANY DEVELOPMENT OF LAND PREVIOUSLY IDENTIFIED AS UNDEVELOPED IN THE APPROVED CONTRIBUTING ZONE PLAN.

Austin Regional Office 12100 Park 35 Circle, Building A Austin, Texas 78753-1808 Phone (512) 339-2929 Fax (512) 339-3795 San Antonio Regional Office 14250 Judson Road San Antonio, Texas 78233-4480 Phone (210) 490-3096 Fax (210) 545-4329

SURVEY NOTES

- BEARING VALUES BASED ON THE TEXAS STATE PLAN COORDINATE SYSTEM, NAD-83, CENTRAL (4203). COORDINATES ARE SURFACE VALUES BASED ON A COMBINED SURFACE ADJUSTMENT FACTOR OF 1.00011. ELEVATIONS BASED UPON GEOID 2012A, PER WESTERN DATA GPS REFERENCE NETWORK.

SUMMARY OF QUANTITIES

505	Encasement Pipe, 20" Dia., Steel (ASTM A134)	50	LF
506-WW	Drop Manhole w/CIP Base, 5' Dia.	1	EA
509	Trench Safety Systems (All Depths)	83	LF
510-WW	Pipe, 10" Dia. PVC SDR-26 (All Depths)	83	LF
559	Concrete Box Culvert, 4 ft. x 4 ft. for temporary bypass	13	VF
506-6038	TEMP SEDMT CONT FENCE (INSTALL)	165	LF
506-6039	TEMP SEDMT CONT FENCE (REMOVE)	165	LF
SP506-BPWW	Temporary Wastewater Bypass Pumping	5	DAY

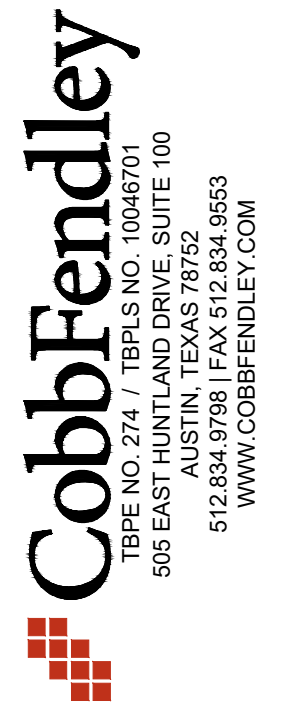

GENERAL NOTES AND SUMMARY OF QUANTITIES
HAIRY MAN 10" WWL RELOCATION
ROUND ROCK, TEXAS



PROJ. NO. 1703-011-10
 DESIGN: K VAN HOOSIER
 DRAWN: H BYRNE
 CHECK: L PRINE
 APPR: S FEES
 DATE: OCTOBER 15, 2020

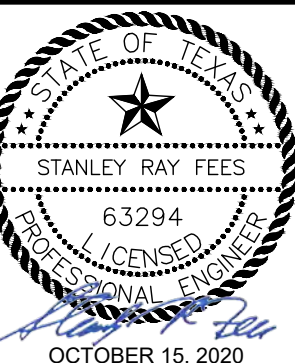

THESE DESIGN DOCUMENTS ARE NOT TO BE USED FOR CONSTRUCTION PRIOR TO REGULATORY SIGNATURE AND PERMIT

SHEET
C-002
 2 of 8

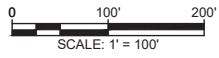

REV. NO.	REVISION DESCRIPTION	APPROVED BY:	DATE

CobbFendley
 TYPE NO. 274 / TRPLS NO. 10046701
 505 EAST HUNTLAND DRIVE, SUITE 100
 AUSTIN, TEXAS 78752
 512.834.9788 | FAX 512.834.9553
 WWW.COBBFENDLEY.COM

KEY MAP
 HAIRY MAN 10" WWL RELOCATION
 ROUND ROCK, TEXAS



PROJ. NO. 1703-011-10
 DESIGN: K. VAN HOOSIER
 DRAWN: H. BYRNE
 CHECK: L. PRINCE
 APPR: S. FEES
 DATE: OCTOBER 24, 2019



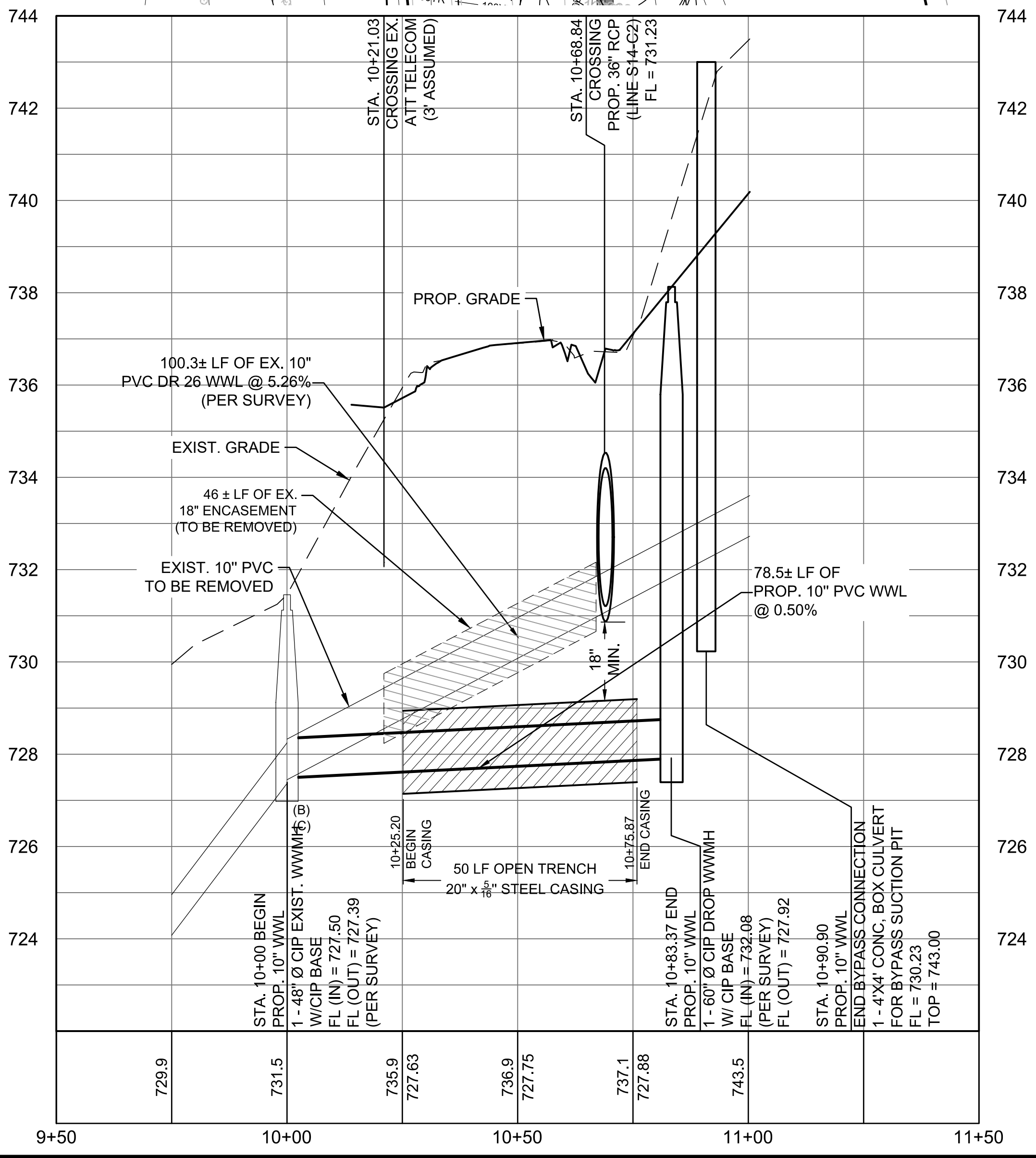
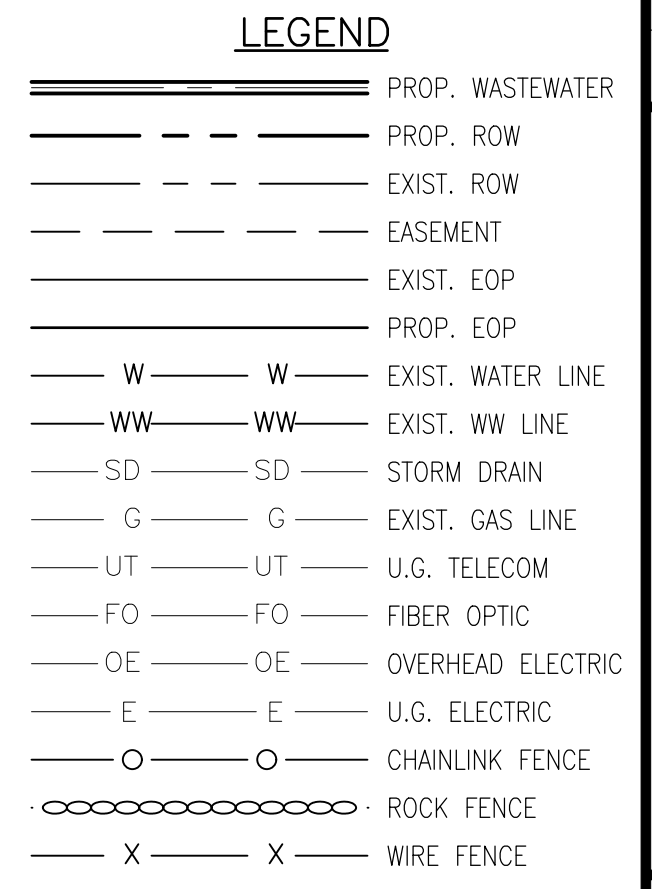
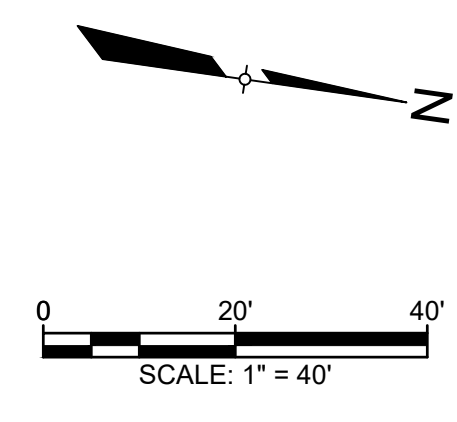
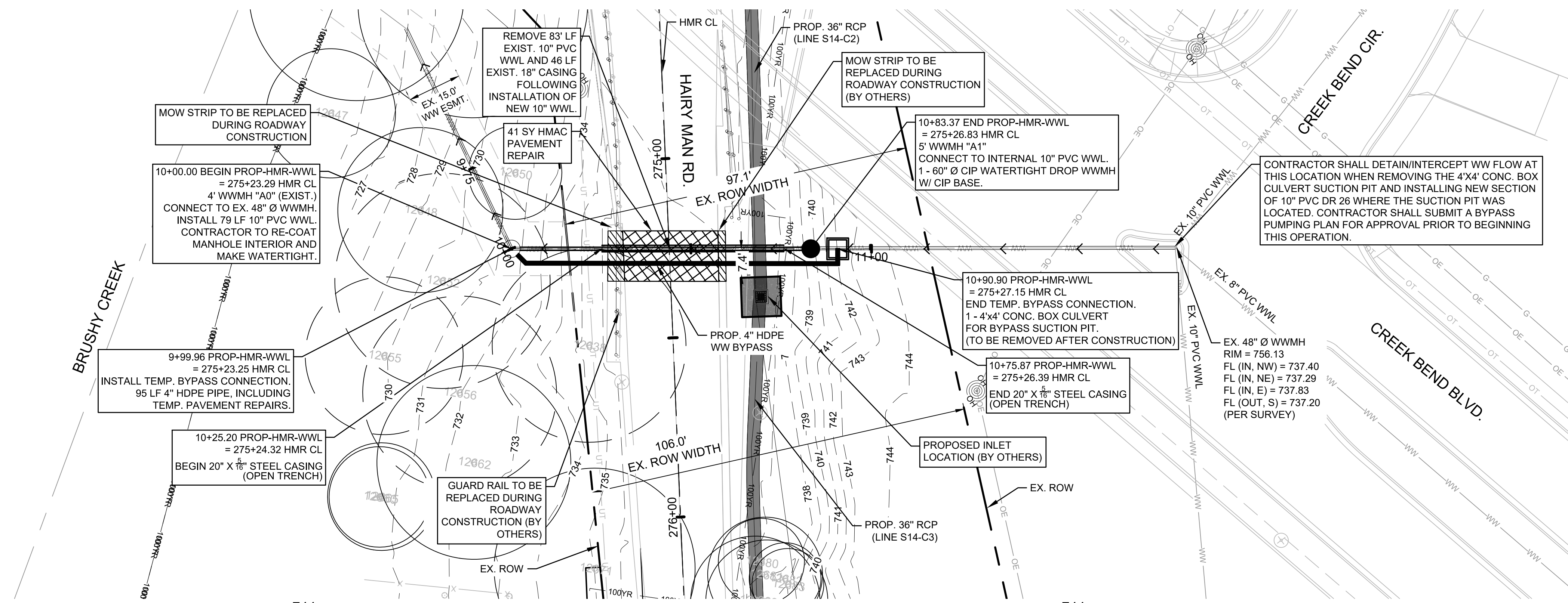

NOTE:
CONTRACTOR MUST MEET/EXCEED THE EXISTING PAVEMENT SECTION WHEN PERFORMING PAVEMENT REPAIRS.

THE CONTRACTOR SHALL HAVE FULL TIME (24 HOUR), ONSITE QUALIFIED PUMP PERSONNEL INCLUDING SUPERVISION FOR MONITORING THE ENTIRE BYPASS INSTALLATION WHILE IT IS IN OPERATION. THE ENTIRE LENGTH OF BYPASS PIPING SHALL BE WALKED AND INSPECTED HOURLY TO MONITOR FOR LEAKS. HIGH LEVEL ALARM NOTIFICATION TO CELL PHONES SHALL NOT ELIMINATE THIS REQUIREMENT. WHERE BYPASS PUMPING SYSTEMS EXCEED 1,500 FEET IN LENGTH CANNOT BE COMPLETELY OBSERVED FROM THE BYPASS PUMP LOCATION, AT LEAST ONE ATTENDANT SHALL BE ASSIGNED TO THE PUMP OPERATION, AND ONE ADDITIONAL ATTENDANT SHALL BE ASSIGNED TO WALK AND MONITOR THE PIPELINE.

ONCE ALL WORK IS COMPLETED AND THE BYPASS PUMPING OPERATION IS NO LONGER REQUIRED, THE CONTRACTOR MUST DISINFECT AND DRAIN THE ENTIRE BPP SYSTEM IN ACCORDANCE WITH APPROVED SUBMITTAL.

(B)
WWMH STA 10+00 TO STA 10+83.37 WITH A 20% SAFETY FACTOR
PEAK WET WEATHER FLOW CAPACITY: 345,600 GPD / 240 GPM / 0.64 CFS
VELOCITY IN 10" PIPE @ 0.5% SLOPE: 2.18 FPS
DEPTH IN 10" PIPE @ 0.5% SLOPE: 0.38 FT

(C)
WWMH STA 10+00 TO STA 10+83.37 WITH FLOW OF 85% FLOW
PEAK WET WEATHER FLOW CAPACITY: 864,000 GPD / 600 GPM / 1.61 CFS
VELOCITY IN 10" PIPE @ 0.5% SLOPE: 2.88 FPS
DEPTH IN 10" PIPE @ 0.5% SLOPE: 0.66 FT

GENERAL NOTES:

- THE LOCATIONS OF EXISTING UNDERGROUND UTILITIES ARE SHOWN IN AN APPROXIMATE WAY ONLY. THE CONTRACTOR SHALL DETERMINE THE EXACT LOCATION OF ALL EXISTING UTILITIES BEFORE COMMENCING WORK AND AGREES TO BE FULLY RESPONSIBLE FOR ANY AND ALL DAMAGES THAT MIGHT BE OCCASIONED BY THE FAILURE TO EXACTLY LOCATE AND PRESERVE ANY AND ALL UNDERGROUND UTILITIES. WHEN THE CONTRACTOR IS USING TRENCHLESS INSTALLATION METHODS, THE CONTRACTOR SHALL LOCATE ALL UTILITIES FOR THE ENTIRE LENGTH OF THE INSTALLATION PRIOR TO ANY ACTIVITIES.
- CONTRACTOR TO MAINTAIN 48" MINIMUM COVER OVER PROPOSED WASTEWATER LINE IN THE STREET AND 42" IN UNPAVED AREAS. CONTRACTOR TO MAINTAIN MINIMUM 18" VERTICAL AND 5' HORIZONTAL CLEARANCE BETWEEN PROPOSED AND EXISTING UTILITIES UNLESS OTHERWISE SHOWN ON THE PLANS.
- ANY DISCREPANCIES FROM WHAT IS SHOWN SHALL BE BROUGHT TO THE ATTENTION OF THE ENGINEER PRIOR TO BEGINNING WORK.
- EXISTING WASTEWATER MAINS CONNECTED TO PROPOSED BYPASS CONNECTION, AND TO EXISTING MANHOLE AT STA 10+00 ARE TO BE PROTECTED AND REMAIN IN SERVICE UNTIL THE NEW MAINS ARE CONSTRUCTED, TESTED, APPROVED AND SERVICE LINES RECONNECTED AND THE NEW MAIN IS PLACED IN SERVICE.

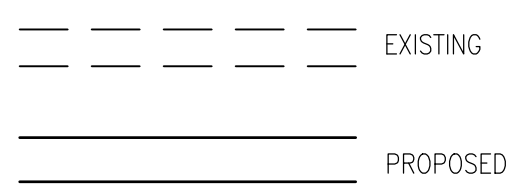

PROFILE SCALE
1"=40' HORIZ.
1"=4' VERT.

REV. NO.	REVISION DESCRIPTION	APPROVED BY:	DATE

CobbFendley
TYPE NO. 274 / TBPLS NO. 1006701
505 EAST HUNTLAND DRIVE, SUITE 100
AUSTIN, TEXAS 78752
512.834.9788 / FAX 512.834.9553
WWW.COBBFENDLEY.COM

PROP. 10" WWL PLAN AND PROFILE STA. 10+00 TO END
HAIRY MAN 10" WWL RELOCATION
ROUND ROCK, TEXAS

WILLIAMSON COUNTY
1848

PROJ. NO. 1703-011-10
DESIGN: K. VAN HOOSIER
DRAWN: H. BYRNE
CHECK: L. PRINCE
APPR: S. FEES
DATE: OCTOBER 7, 2020



09/08/20

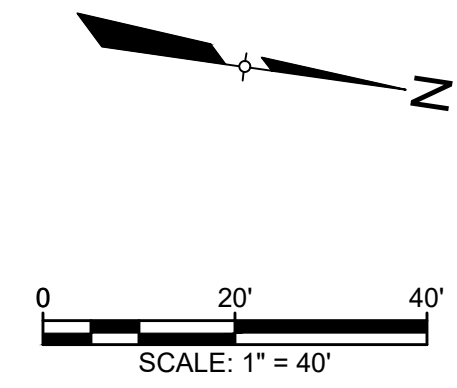
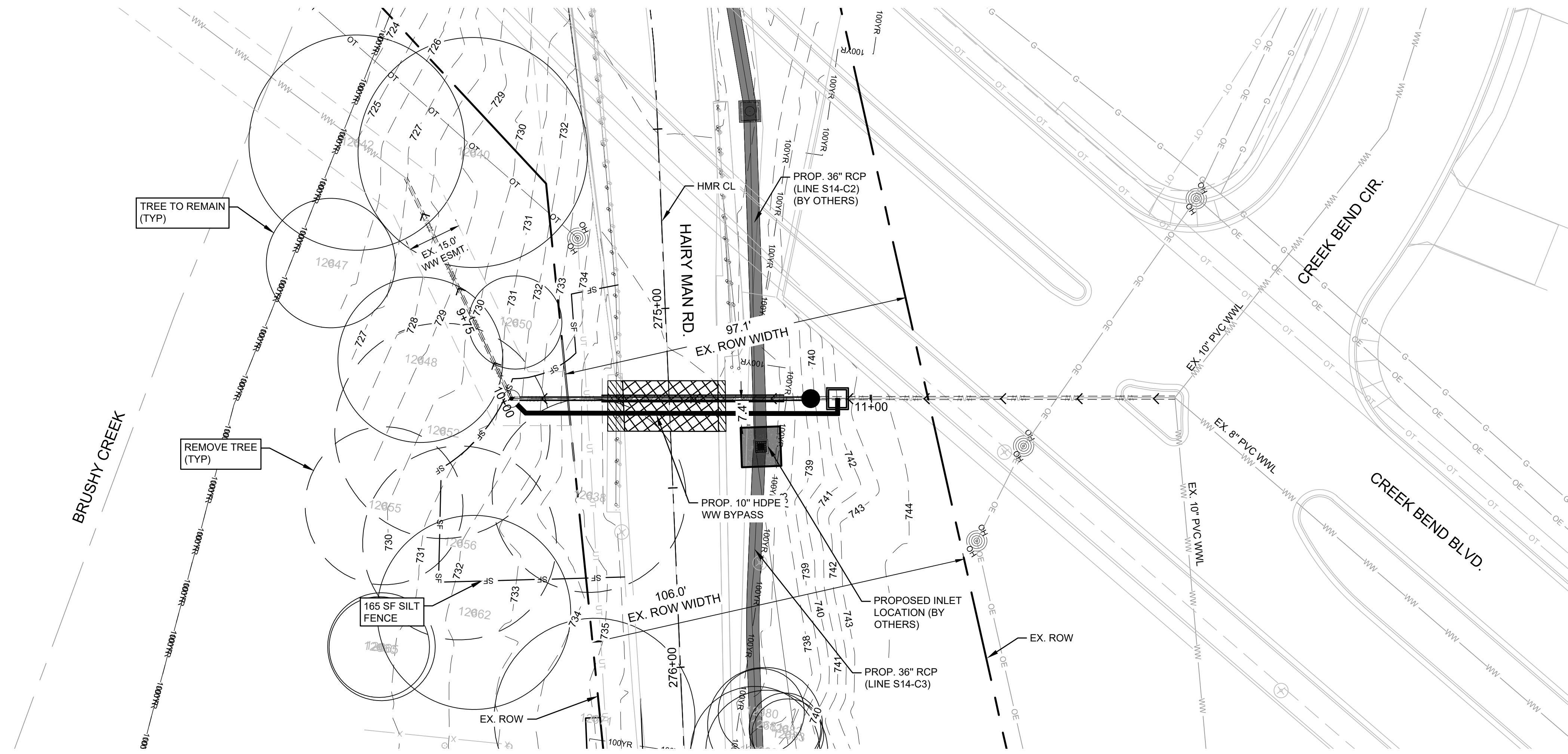

LEGEND

	PROP. WASTEWATER
	PROP. ROW
	EXIST. ROW
	EASEMENT
	EXIST. EOP
	PROP. EOP
	W - W EXIST. WATER LINE
	WW - WW EXIST. WW LINE
	SD - SD STORM DRAIN
	G - G EXIST. GAS LINE
	UT - UT U.G. TELECOM
	FO - FO FIBER OPTIC
	OE - OE OVERHEAD ELECTRIC
	E - E U.G. ELECTRIC
	X - X CHAINLINK FENCE
	ROCK FENCE
	WIRE FENCE

	EXIST. TREE (TO REMAIN)
	EXIST. TREE (TO BE REMOVED)

GENERAL NOTES:

1. THE LOCATIONS OF EXISTING UNDERGROUND UTILITIES ARE SHOWN IN AN APPROXIMATE WAY ONLY. THE CONTRACTOR SHALL DETERMINE THE EXACT LOCATION OF ALL EXISTING UTILITIES BEFORE COMMENCING WORK AND AGREES TO BE FULLY RESPONSIBLE FOR ANY AND ALL DAMAGES THAT MIGHT BE OCCASIONED BY THE FAILURE TO EXACTLY LOCATE AND PRESERVE ANY AND ALL UNDERGROUND UTILITIES. WHEN THE CONTRACTOR IS USING TRENCHLESS INSTALLATION METHODS, THE CONTRACTOR SHALL LOCATE ALL UTILITIES FOR THE ENTIRE LENGTH OF THE INSTALLATION PRIOR TO ANY ACTIVITIES.
2. CONTRACTOR TO MAINTAIN 48" MINIMUM COVER OVER PROPOSED WASTEWATER LINE IN THE STREET AND 42" IN UNPAVED AREAS. CONTRACTOR TO MAINTAIN MINIMUM 18" VERTICAL AND 5' HORIZONTAL CLEARANCE BETWEEN PROPOSED AND EXISTING UTILITIES UNLESS OTHERWISE SHOWN ON THE PLANS.
3. ANY DISCREPANCIES FROM WHAT IS SHOWN SHALL BE BROUGHT TO THE ATTENTION OF THE ENGINEER PRIOR TO BEGINNING WORK.
4. EXISTING WASTEWATER MAINS CONNECTED TO PROPOSED BYPASS CONNECTION, AND TO EXISTING MANHOLE AT STA 10+00 ARE TO BE PROTECTED AND REMAIN IN SERVICE UNTIL THE NEW MAINS ARE CONSTRUCTED, TESTED, APPROVED AND SERVICE LINES RECONNECTED AND THE NEW MAIN IS PLACED IN SERVICE.

TREE LIST

POINT #	TAG #	DRIP DIA.	SIZE	DESCRIPTION	STATUS
735.436	12638	27"	27"	CEDAR ELM	REMOVE
725.175	12647	18"	18"	CEDAR ELM	-
729.087	12648	23"	23"	CEDAR ELM	-
731.331	12650	13"	13"	CEDAR ELM	-
730.720	12652	30"	30"	CEDAR ELM	REMOVE
729.972	12655	22"	22"	CEDAR ELM	REMOVE
732.031	12656	27"	27"	CEDAR ELM	REMOVE
730.342	12660	14"	14"	CEDAR ELM	-
732.762	12662	27"	27"	CEDAR ELM	-
730.831	12665	15"	15"	OAK	-
735.089	12671	28"	28"	OAK	-
737.791	12680	12',12"	12',12"	OAK	-
738.060	12681	16"	16"	OAK	-
738.237	12682	10',4"	10',4"	OAK	-
738.105	12683	10"	10"	OAK	-

REV. NO.	REVISION DESCRIPTION	APPROVED BY:	DATE

CobbFendley
 TBE# NO. 274 / TBE# NO. 10046701
 505 EAST HUNTLAND DRIVE, SUITE 100
 AUSTIN, TEXAS 78752
 512.834.9788 / FAX 512.834.9553
 WWW.COBBFENDLEY.COM

EROSION CONTROL SHEET
 HAIRY MAN 10" WWL RELOCATION
 ROUND ROCK, TEXAS

WILLIAMSON COUNTY
 1846

PROJ. NO. 1703-011-10
 DESIGN: K. VAN HOOSIER
 DRAWN: H. BYRNE
 CHECK: L. PRINCE
 APPR: S. FEES
 DATE: OCTOBER 15, 2020

STATE OF TEXAS
 63294
 (CENSUS)
 PROFESSIONAL ENGINEER
 OCTOBER 15, 2020

THESE DESIGN DOCUMENTS ARE NOT TO BE USED FOR CONSTRUCTION PRIOR TO REGULATORY SIGNATURE AND PERMIT.

PIPE SIZE-CARRIER (DIAMETER)	PIPE SIZE-CASING (DIAMETER) (MIN.)	MINIMUM PIPE THICKNESS (INCHES)
6"	16"	1/4
8"	18"	1/4
10"	20"	5/16
12" ~ 14"	24"	3/8
16" ~ 18"	30"	7/16
20"	36"	1/2
24"	42"	1/2
30"	48"	1/2

NOTES:

- CASING SPACER CONFIGURATION AND SPACING SHALL BE AS SHOWN ON MANUFACTURER'S DRAWINGS FOR SPECIFIC WORK; THESE MUST BE ACCEPTABLE TO THE CITY OF ROUND ROCK.
- CASING SPACER SHALL BE AS MANUFACTURED BY CASCADE WATERWORKS MANUFACTURING COMPANY, MODEL CCS, OR APPROVED EQUAL.

RECORD SIGNED COPY ON FILE AT U&S DEPARTMENT APPROVED
 DATE: 03-01-18
CITY OF ROUND ROCK
 PIPE ENCASEMENT DETAIL
 DRAWING NO: WT-16

NOTES:

- IF DROP IS SIX INCHES (6") TO TWO FEET (2'-0"), CONSTRUCTION OF DROP SHALL PROVIDE AN OVERSIZED INVERT TO EXTEND UNDER THE DROP CONNECTION.
- SEE CONSTRUCTION PLANS FOR MANHOLE SIZE, LOCATION, CONFIGURATION, TYPE OF TOP SECTION, VENTING REQUIREMENTS, PIPE SIZES AND TYPES.
- MANHOLES SHALL BE PRECAST A.S.T.M. C478 BELL AND SPIGOT WITH 10" RING JOINTS.
- MANHOLES TO BE DESIGNED TO RESIST LATERAL AND VERTICAL SOIL FORCES RESULTING FROM MANHOLE DEPTH. ADDITIONALLY, MANHOLES LOCATED IN PAVEMENT TO BE DESIGNED FOR H2O TRAFFIC LOADING.
- ALL MANHOLE COVERS SHALL BE BOLTED AND GASKETED, WHEN MANHOLES ARE LOCATED OUTSIDE OF PAVEMENT.
- FRAME ADJUSTMENT HEIGHT SHALL CONSIST OF FIVE INCHES (5") MINIMUM TO EIGHTEEN INCHES (18") MAXIMUM. GRADE RINGS SHALL BE GROUTED WITH A NON-SHRINK GROUT INSIDE AND OUTSIDE. HDPE GRADE RINGS, MAY NOT BE USED.
- FOR MANHOLES TO BE VENTED, SEE DETAILS WW-05 AND WW-06.
- A FLOW CHANNEL SHALL BE CONSTRUCTED INSIDE MANHOLE TO DIRECT INFLUENT INTO THE FLOW STREAM. ALL P.V.C. PIPE SHALL BE REMOVED FROM INVERT.
- BASE SECTION SHALL BE DESIGNED FOR H2O LOADING, PLUS EARTH LOAD AT 130 PCF.
- ENTIRE INTERIOR CONCRETE SURFACES OF WASTEWATER MANHOLES TO BE COATED WITH RAVEN 405, SPRAYWALL, OR APPROVED EQUAL, WITH A UNIFORM THICKNESS OF 124 MILS AND A MINIMUM THICKNESS OF 100 MILS, APPLIED AFTER MANHOLE HAS PASSED THE VACUUM TEST). FOR REHABILITATING MANHOLES 1/2" MINIMUM THICKNESS CALCIUM ALUMINATE CEMENTITIOUS COATING AND OTHER INTERIOR SURFACES MAY BE COATED IF RECOMMENDED BY COATING MANUFACTURER. (IN LIEU OF INTERIOR COATINGS NEW PRECAST MANHOLES CONTAINING CONSHIELD WILL BE ACCEPTED PROVIDING THE MANUFACTURER STENCILS "CONSHIELD" ON THE INSIDE AND OUTSIDE OF ALL MANHOLE SECTIONS.)

RECORD SIGNED COPY ON FILE AT U&S DEPARTMENT APPROVED
 DATE: 03-01-18
CITY OF ROUND ROCK
 PRECAST CONCRETE WASTEWATER MANHOLE DETAIL
 DRAWING NO: WW-01

NOTES:

- SEE NOTES #2 THROUGH #10 ON DETAIL WW-01.
- DROP SERVICES SHALL BE REQUIRED WHENEVER AN INFLUENT SEWER SERVICE IS LOCATED MORE THAN TWO FEET (2'-0") ABOVE THE MAIN INVERT CHANNEL.
- WHEN P.V.C. PIPE IS USED IN SANITARY SEWER LINES, SOLVENT TYPE JOINT P.V.C. FITTINGS TO BE UTILIZED IN THE DROP ASSEMBLY ONLY. FITTINGS TO BE PVC SDR-35 WITH A TWO PART WATER RESISTANT GLUE AT ALL JOINTS.
- A 5'-0" MANHOLE IS REQUIRED FOR 1 OR 2 DROP SERVICES. IF THERE ARE MORE THAN 2 DROP SERVICES, A 6'-0" DIAMETER MANHOLE IS REQUIRED.

RECORD SIGNED COPY ON FILE AT U&S DEPARTMENT APPROVED
 DATE: 03-01-18
CITY OF ROUND ROCK
 PRECAST CONCRETE WASTEWATER MANHOLE WITH DROP SERVICE DETAIL
 DRAWING NO: WW-03

NOTES:

- CAST-IN-PLACE BASE SHALL BE 4000 TO 4500 P.S.I. CONCRETE, 28 DAY STRENGTH.
- STEEL SHALL BE GRADE 60.
- MANHOLE RISER PIPE FURNISHED IN LENGTHS OF ONE (1), TWO (2), THREE (3), FOUR (4) OR SIX (6) FEET AND SHALL BE IN ACCORDANCE WITH A.S.T.M. C478.
- INVERT CHANNEL SHALL BE PROVIDED THAT AS MUCH AS POSSIBLE, FORMS A SMOOTH CONTINUATION OF INLET AND OUTLET PIPES.
- BASE SHALL BE PROPERLY FORMED IN THE FIELD WITH WOOD OR OTHER APPROVED FORMS.
- VERTICAL BARS MAY BE EXTENSIONS OF BOTTOM STEEL OR SEPARATE FROM, BUT TIED TO BOTTOM HORIZONTAL STEEL.

RECORD SIGNED COPY ON FILE AT U&S DEPARTMENT APPROVED
 DATE: 03-01-18
CITY OF ROUND ROCK
 CAST-IN-PLACE BASE FOR CONCRETE WASTEWATER MANHOLE DETAIL
 DRAWING NO: WW-04

NOTES:

- COVER AND FRAME SHALL COMPLY WITH STANDARD SPECIFICATIONS FOR DRAINAGE, SEWER, UTILITY AND RELATED CASTINGS: AASHTO DESIGNATION M306-04.
- MANHOLE COVER SHALL BE MODEL NUMBER: V-2432-3 (PRODUCT NUMBER: 42432033), AS MANUFACTURED BY EAST JORDAN IRON WORKS INCORPORATED, OR APPROVED EQUAL.
- MANHOLE FRAME SHALL BE MODEL NUMBER: V-2432 (PRODUCT NUMBER: 42432010), AS MANUFACTURED BY EAST JORDAN IRON WORKS INCORPORATED, OR APPROVED EQUAL.
- MANHOLE COVER AND FRAME ASSEMBLY, IF ORDERED AS A SET, SHALL BE MODEL NUMBER: V-2432 (PRODUCT NUMBER: 42432073), AS MANUFACTURED BY EAST JORDAN IRON WORKS INCORPORATED, OR APPROVED EQUAL.
- ALL CORNERS AND EDGES SHALL HAVE A 1/16" MINIMUM AND 1/8" MAXIMUM RADIUS.
- MANHOLE COVERS SHALL BE CAST WITH TWO 1" DIAMETER STEEL PICKBARS.
- MANHOLE COVER WEIGHT SHALL BE 175 LBS. FOR DUCTILE IRON, WEIGHT SHALL BE CAST ON BOTH TOP AND BOTTOM OF COVER.
- MANUFACTURER SHALL CERTIFY THAT EACH MANHOLE COVER MEETS HS-20 LOADING.
- FILLETS SHALL BE 1/4" RADIUS UNLESS OTHERWISE SPECIFIED.
- MANUFACTURER SHALL REMOVE EXCESS IRON AND MACHINE FINISH SEATING SURFACES TO NOTED DIMENSIONS.
- COVER SHALL BE DIPPED IN A WATER-BASED ASPHALTIC COATING, PRIOR TO SHIPMENT FROM FOUNDRY.
- BOLTS SHALL BE 5/8"-11NC X 2" LONG-HEX STAINLESS STEEL WITH WASHER.
- MANUFACTURER SHALL DRILL 2-3/16" X 1/2" DEEP HOLES FOR A MANHOLE NUMBER PLATE TO BE PROVIDED BY THE CITY OF ROUND ROCK. THE TOP HOLE SHALL BE DRILLED 1" O.C. FROM THE BOTTOM OF THE PICKBAR AND THE BOTTOM HOLE SHALL BE DRILLED 4" O.C. FROM THE TOP HOLE.

RECORD SIGNED COPY ON FILE AT U&S DEPARTMENT APPROVED
 DATE: 03-01-18
CITY OF ROUND ROCK
 BOLTED WASTEWATER MANHOLE COVER AND FRAME DETAIL
 DRAWING NO: WW-07

NOTE:

CONCENTRIC CONCRETE CONE SECTION SHALL BE MANUFACTURED USING 4000 TO 4500 P.S.I. CONCRETE, 28 DAY STRENGTH AND IN ACCORDANCE WITH A.S.T.M. C478, AS MANUFACTURED BY CONCRETE PRODUCTS INCORPORATED, OR APPROVED EQUAL.

RECORD SIGNED COPY ON FILE AT U&S DEPARTMENT APPROVED
 DATE: 03-01-18
CITY OF ROUND ROCK
 PRECAST 48" CONCENTRIC CONCRETE CONE SECTION DETAIL
 DRAWING NO: WW-09

NOTE:

- FLEXIBLE "SEAL BOOT" RESILIENT CONNECTOR TO BE A MINIMUM OF 12 INCHES (12") FROM A MANHOLE JOINT.

RECORD SIGNED COPY ON FILE AT U&S DEPARTMENT APPROVED
 DATE: 03-01-18
CITY OF ROUND ROCK
 FLEXIBLE "SEAL BOOT" RESILIENT CONNECTOR DETAIL
 DRAWING NO: WW-10

NOTES:

- MINIMUM DROP FROM INLET TO OUTLET OF MANHOLE IS 0.1 FEET AND MAXIMUM DROP IS 2 FEET, UNLESS SPECIAL APPROVAL IS OBTAINED FROM THE CITY OF ROUND ROCK.
- INVERT CHANNELS TO BE CONSTRUCTED FOR SMOOTH FLOW WITH NO OBSTRUCTIONS.
- SPILLWAYS SHALL BE CONSTRUCTED BETWEEN PIPES WITH DIFFERENT INVERT ELEVATIONS PROVIDING FOR SMOOTH FLOW.
- CHANNELS FOR FUTURE CONSTRUCTIONS, SHALL BE CONSTRUCTED WITH PIPE EXTENDING 3' BEYOND EXTERIOR OF MANHOLE WALL, WITH GROUTED PLUG.
- SLOPE MANHOLE BENCH AT 2:1 SLOPE FROM MANHOLE WALL TO CHANNEL.
- INVERT CHANNEL SHALL BE A MINIMUM OF 1/2 THE DIAMETER OF THE LARGEST PIPE OR FOUR INCHES (4") DEEP.

RECORD SIGNED COPY ON FILE AT U&S DEPARTMENT APPROVED
 DATE: 03-01-18
CITY OF ROUND ROCK
 WASTEWATER FLOW PATTERNS FOR INVERT CHANNELS DETAIL
 DRAWING NO: WW-11

STANDARD DETAILS - SHEET 1

HAIRY MAN 10" WWL RELOCATION ROUND ROCK, TEXAS

WILLIAMSON COUNTY 1848

CobbFendley
 TYPE NO. 274 / TBPLS NO. 10046701
 505 EAST HUNTLAND DRIVE, SUITE 100
 AUSTIN, TEXAS 78752
 512.834.9788 / FAX 512.834.9853
 WWW.COBBFENDLEY.COM

APPROVED BY: _____ DATE: _____

REVISION DESCRIPTION

REV. NO. _____

PROJ. NO. 1703-011-10
 DESIGN: K. VAN HOOSIER
 DRAWN: H. BYRNE
 CHECK: L. PRINE
 APPR: S. FEEES
 DATE: OCTOBER 7, 2020

STATE OF TEXAS
 63294
 REGISTERED PROFESSIONAL ENGINEER
 OCTOBER 7, 2020

THESE DESIGN DOCUMENTS ARE NOT TO BE USED FOR CONSTRUCTION PRIOR TO REGULATORY SIGNATURE AND PERMIT

SHEET C-501 6 OF 8

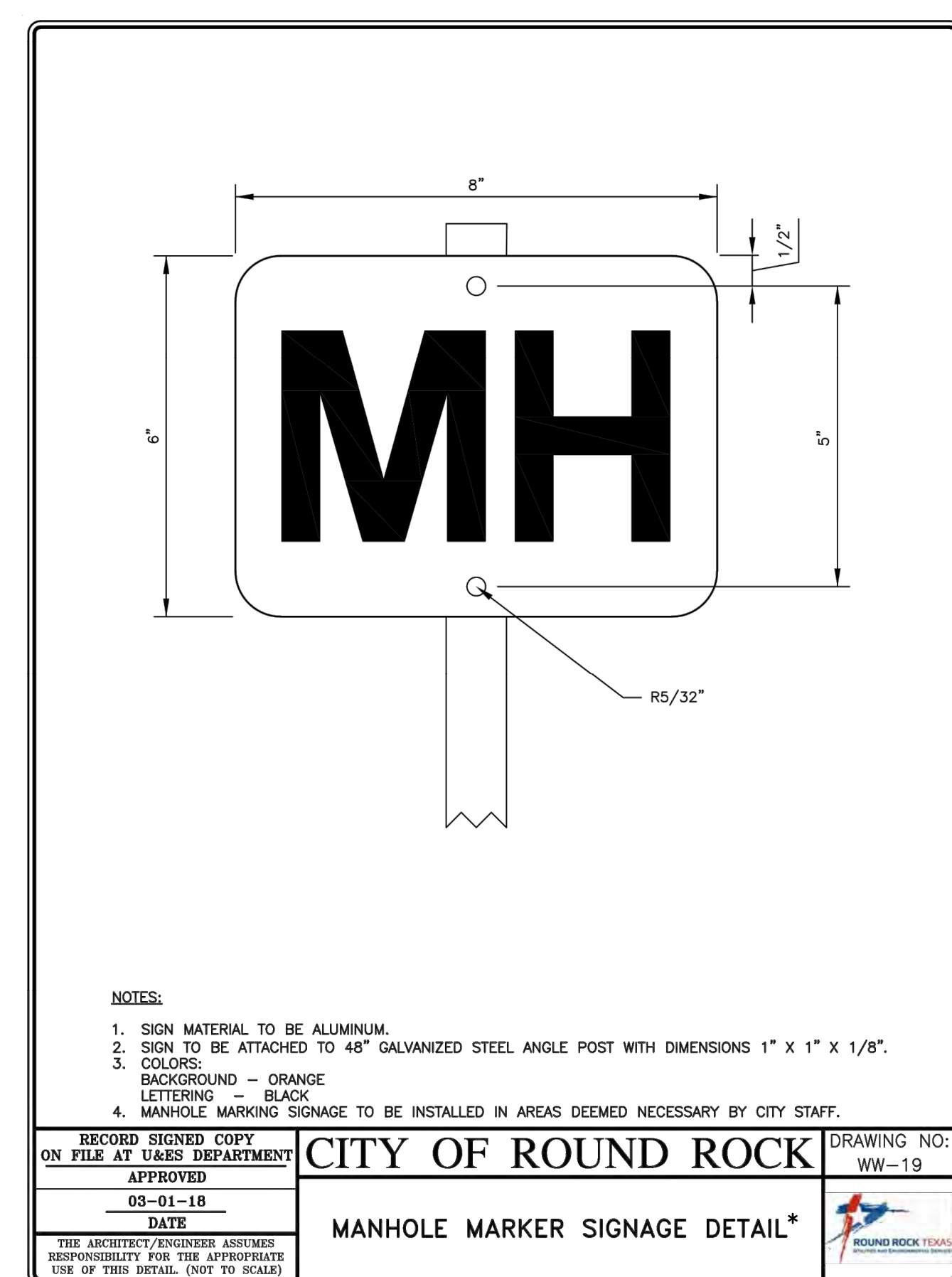
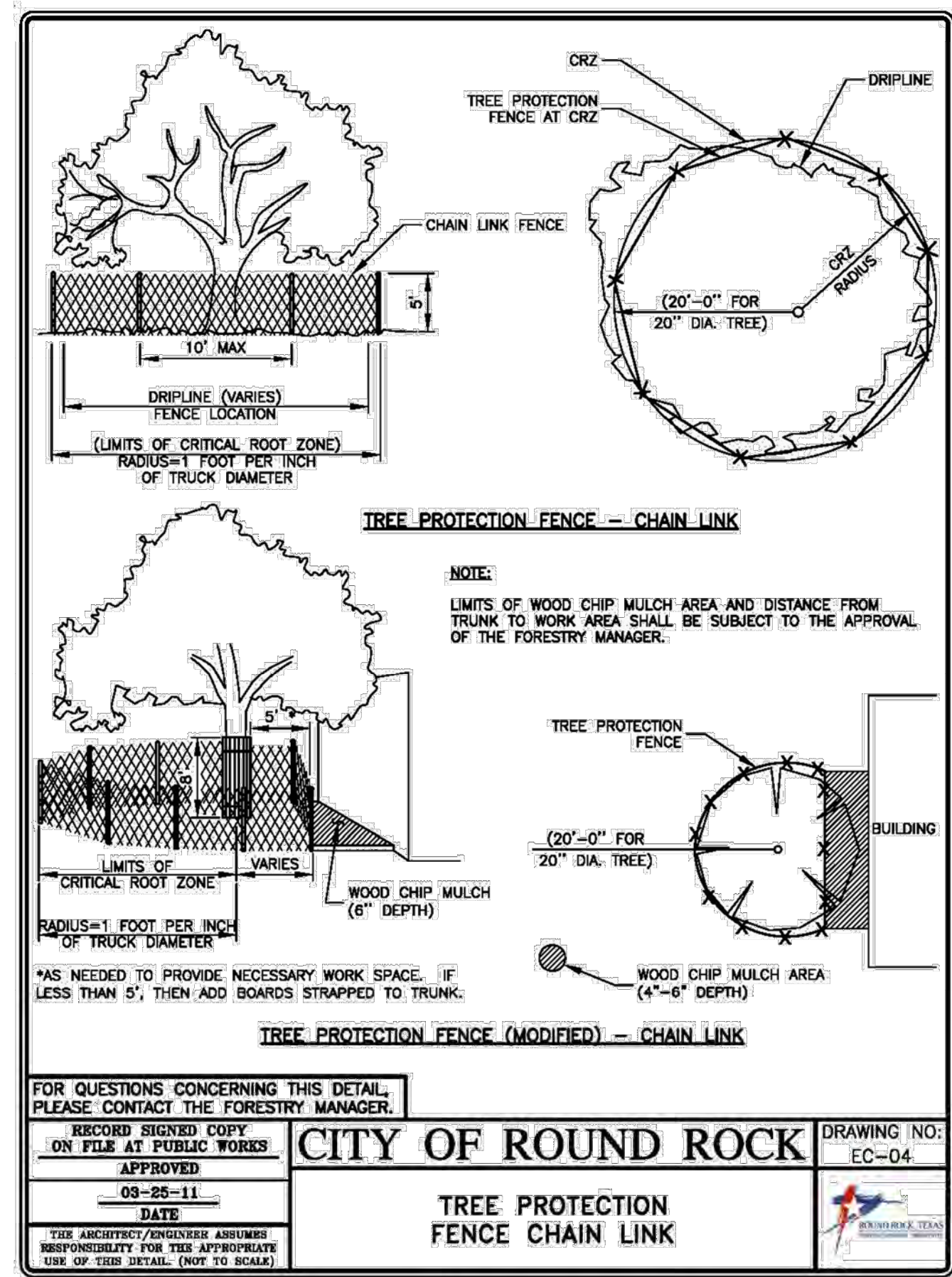
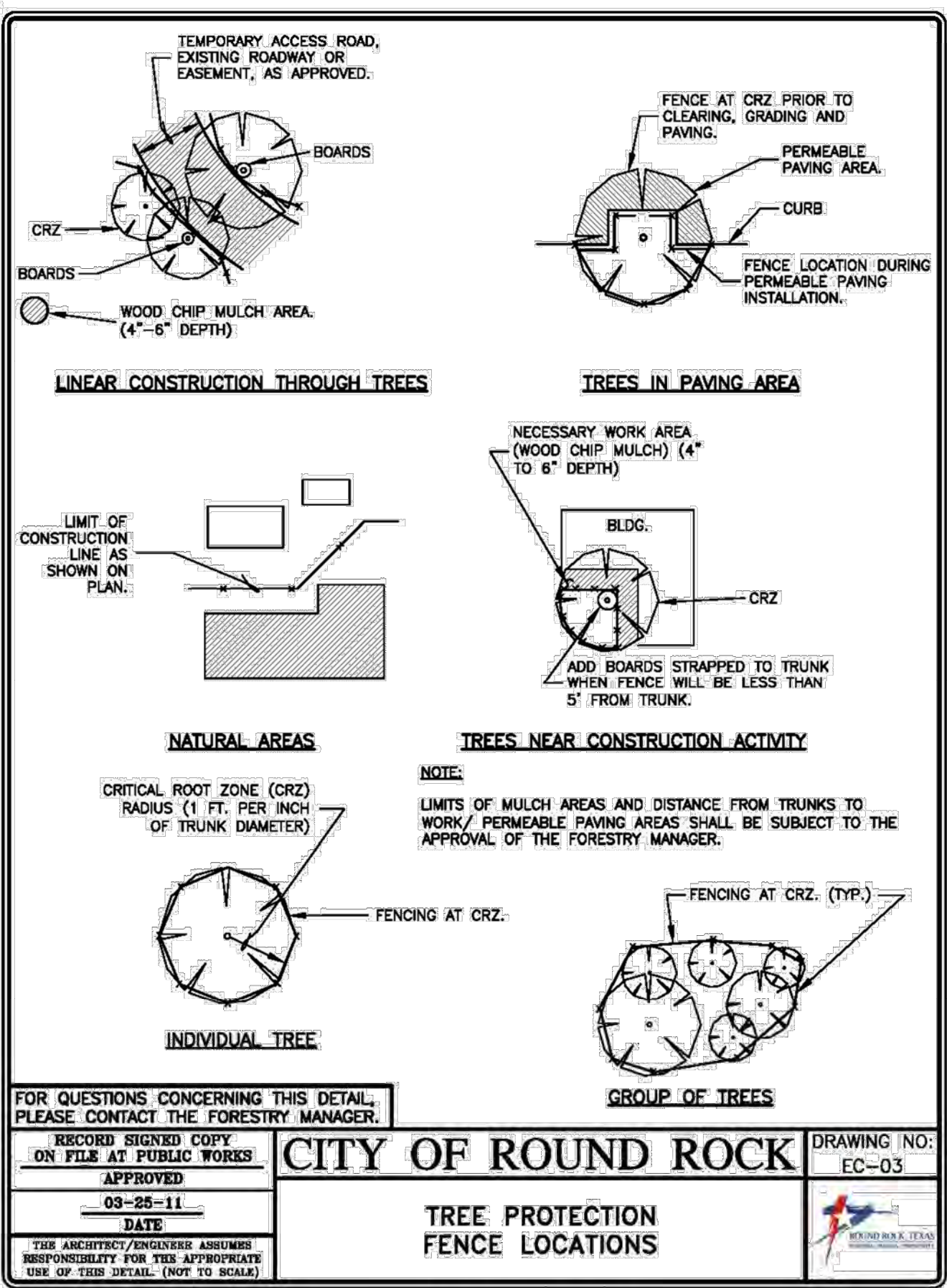
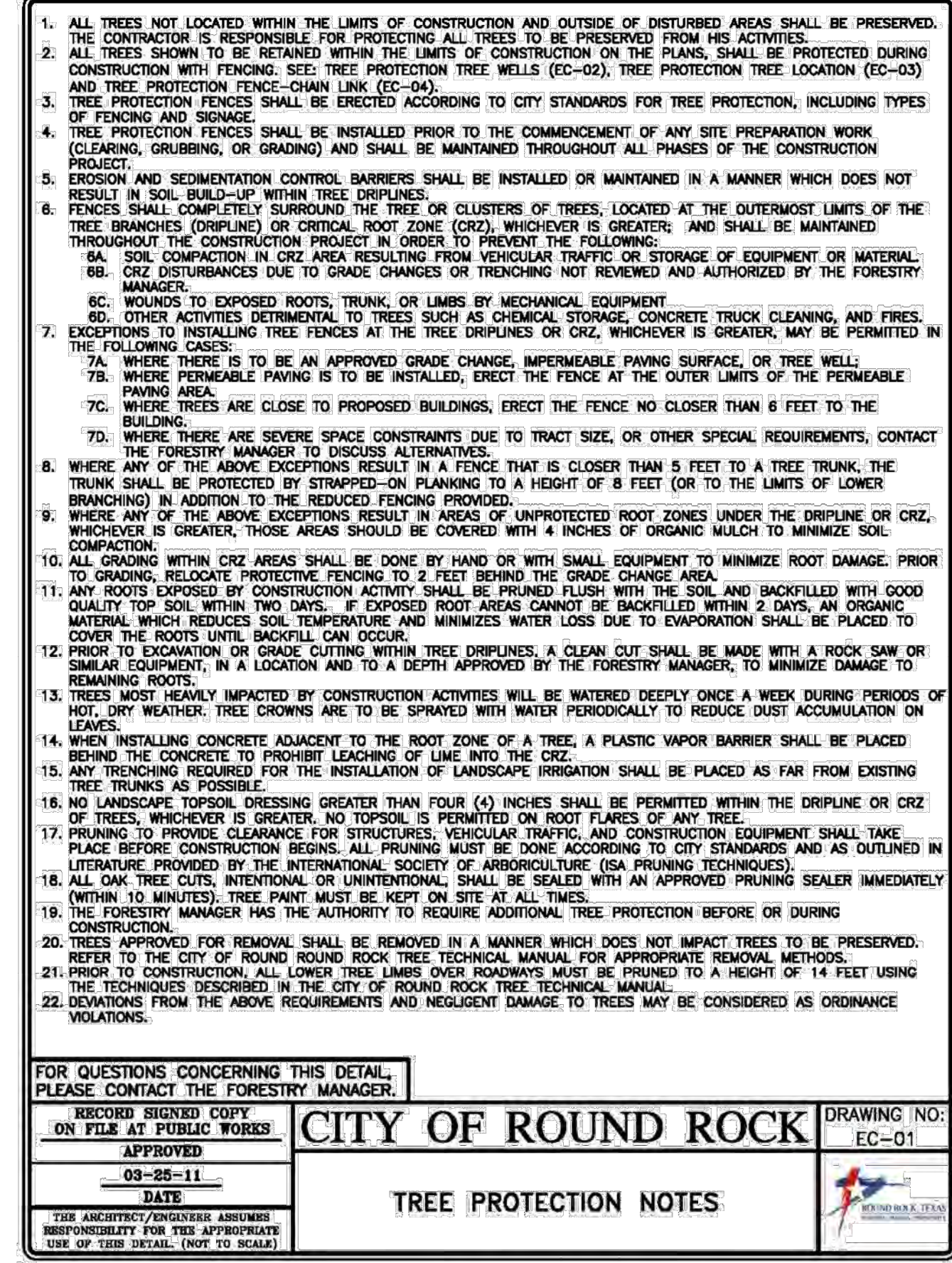
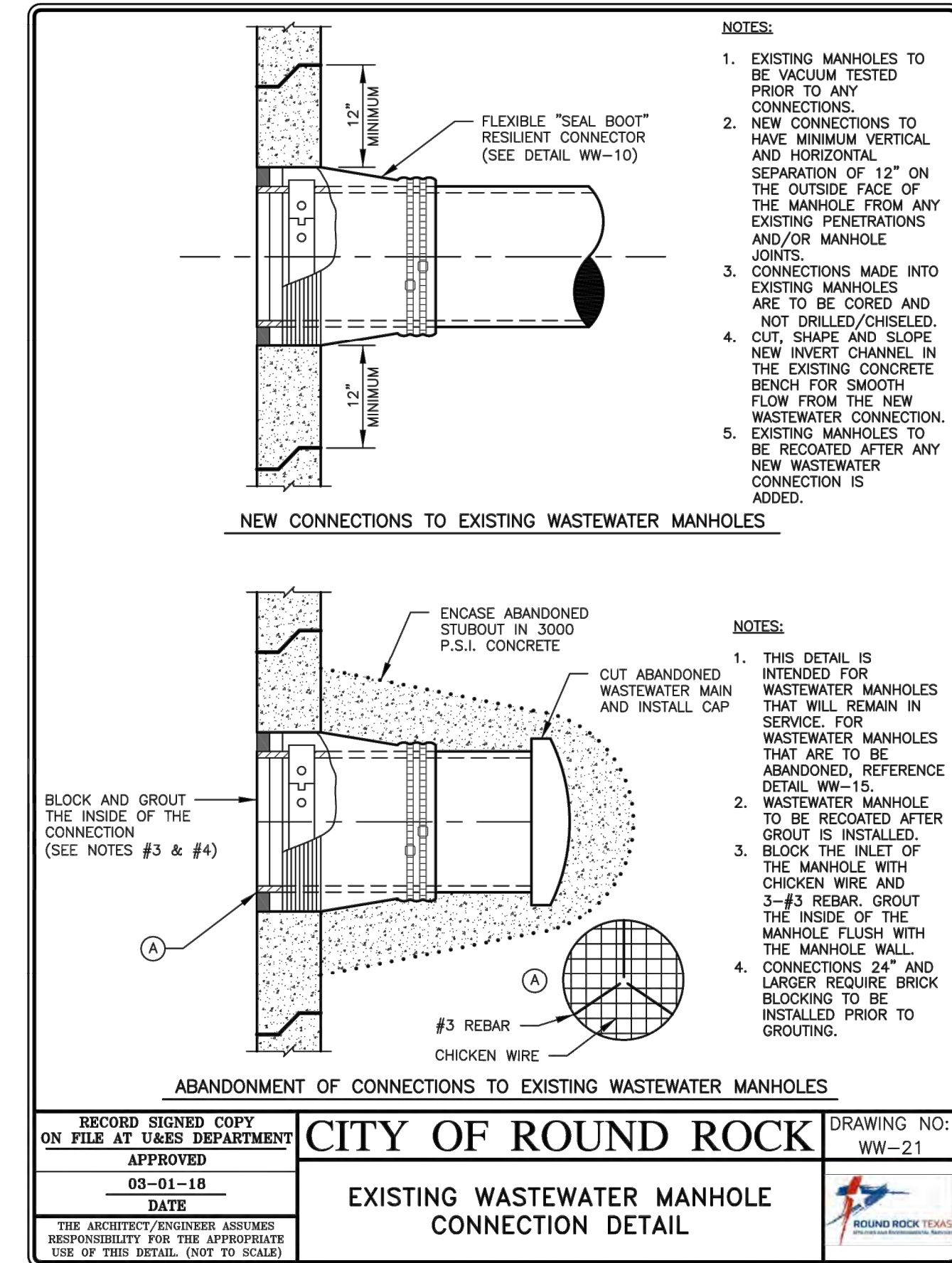
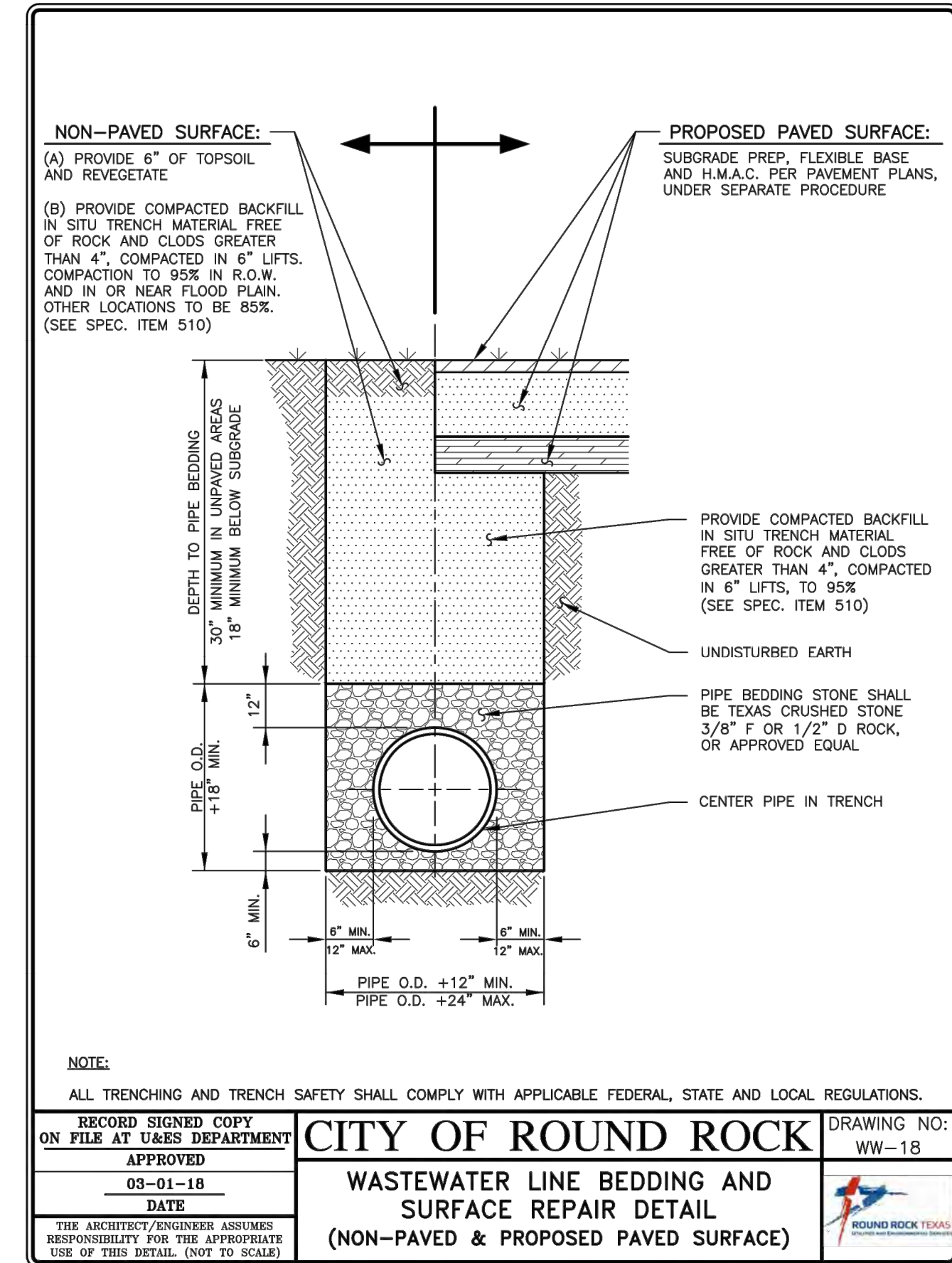
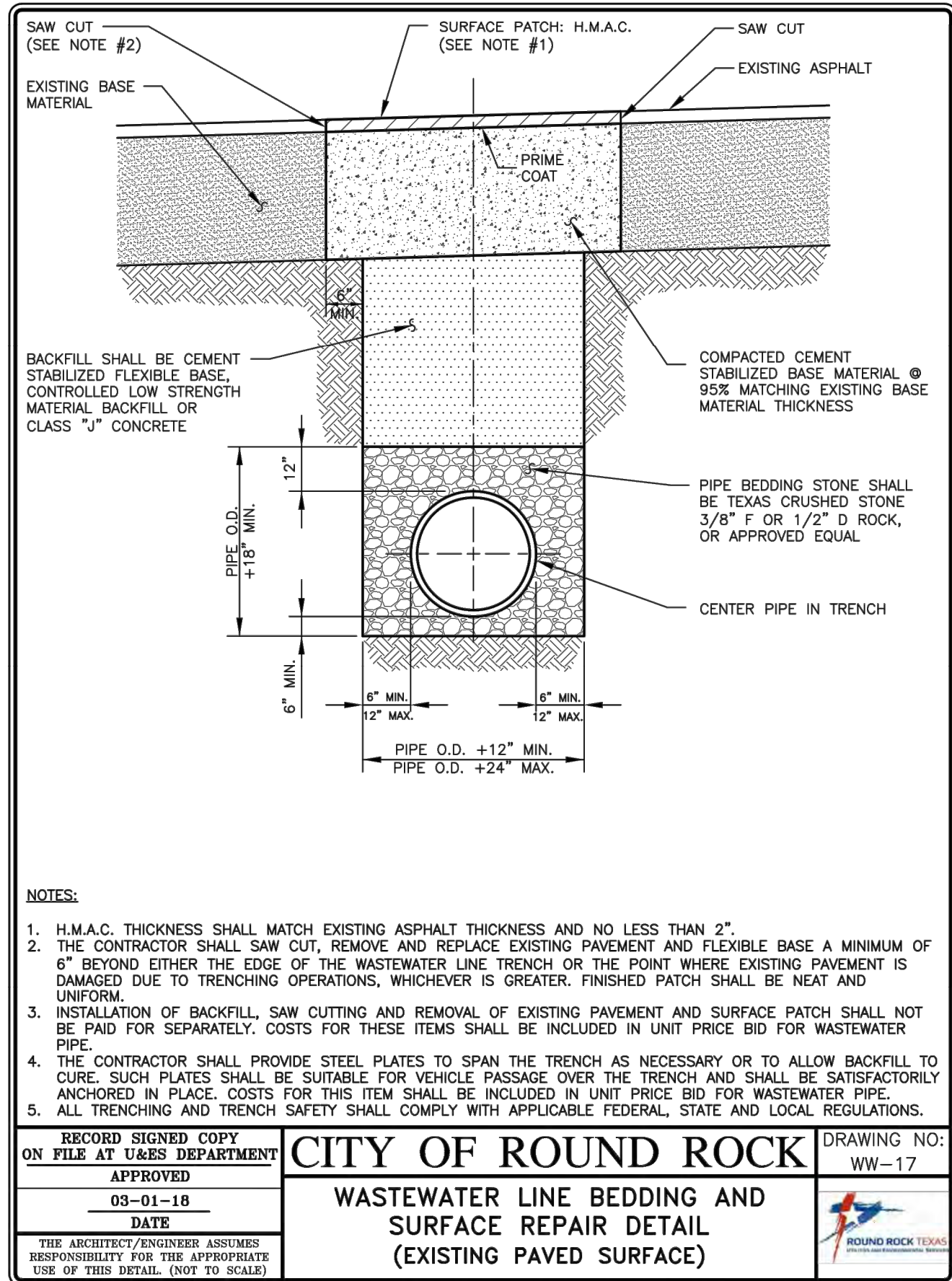

SPECIAL PROVISION NOTE
 * WHEN DEEMED NECESSARY BY THE CITY OF ROUND ROCK STAFF, MANHOLE MARKER SIGNAGE SHALL BE MADE SUBSIDIARY TO PAYMENT FOR MANHOLE INSTALLATION.

DATE: _____
 APPROVED BY: _____
 REVISION DESCRIPTION: _____
 REV. NO. _____

CobbFendley
 TEXAS REG. NO. 274 / TBPIS NO. 10046701
 505 EAST HUNTLAND DRIVE, SUITE 100
 AUSTIN, TEXAS 78752
 512.834.9788 / FAX 512.834.9553
 WWW.COBBFENDLEY.COM

STANDARD DETAILS - SHEET 2
 HAIRY MAN 10" WWL RELOCATION
 ROUND ROCK, TEXAS

WILLIAMSON COUNTY
 1848

PROJ. NO. 1703-011-10
 DESIGN: K. VAN HOOSIER
 DRAWN: H. BYRNE
 CHECK: L. PRINCE
 APPR: S. FEES
 DATE: OCTOBER 7, 2020

63294
 CENSORED
 PROFESSIONAL ENGINEER
 OCTOBER 7, 2020

THESE DESIGN DOCUMENTS ARE NOT TO BE USED FOR CONSTRUCTION PRIOR TO REGULATORY SIGNATURE AND PERMIT

SHEET
C-502
 7 OF 8

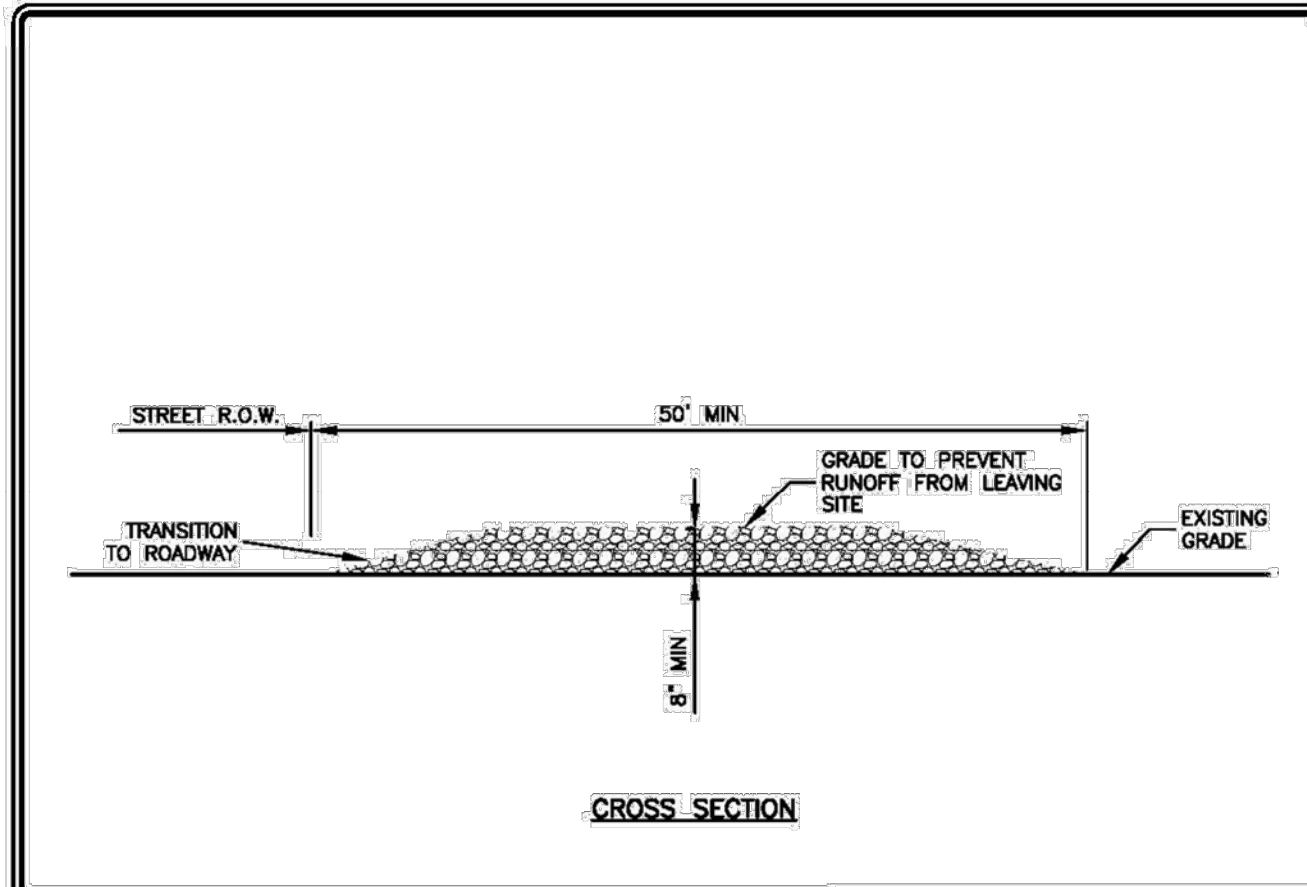

NOTES:

1. STONE SIZE SHALL BE 3" - 6" OPEN GRADED ROCK.
2. THICKNESS OF CRUSHED STONE PAD TO BE NOT LESS THAN 8".
3. LENGTH SHALL BE A MINIMUM OF 50' FROM ACTUAL ROADWAY, AND WIDTH NOT LESS THAN FULL WIDTH OF INGRESS/EGRESS.
4. ENTRANCE SHALL BE PROPERLY GRADED TO PREVENT RUNOFF FROM LEAVING THE CONSTRUCTION SITE.
5. THE ENTRANCE SHALL BE MAINTAINED IN A CONDITION WHICH WILL PREVENT TRACKING OR FLOWING OF SEDIMENT ONTO PUBLIC RIGHTS OF WAY. ALL SEDIMENT SPILLED, DROPPED, WASHED OR TRACKED ONTO PUBLIC RIGHTS OF WAY MUST BE REMOVED IMMEDIATELY BY CONTRACTOR.
6. AS NECESSARY, WHEELS MUST BE CLEANED TO REMOVE SEDIMENT PRIOR TO ENTRANCE ONTO PUBLIC RIGHT OF WAY. WHEN WASHING IS REQUIRED, IT SHALL BE DONE ON AN AREA STABILIZED WITH CRUSHED STONE WHICH DRAINS INTO AN APPROVED SEDIMENT TRAP OR SEDIMENT BASIN. ALL SEDIMENT SHALL BE PREVENTED FROM ENTERING ANY STORM DRAIN, DITCH OR WATERCOURSE USING APPROVED METHODS.

RECORD SIGNED COPY ON FILE AT PUBLIC WORKS	CITY OF ROUND ROCK	DRAWING NO. EC-09
APPROVED	STABILIZED CONSTRUCTION ENTRANCE DETAIL	
DATE 09-28-11		
THE ARCHITECT/ENGINEER ASSUMES RESPONSIBILITY FOR THE APPROPRIATE USE OF THIS DETAIL. (NOT TO SCALE)		

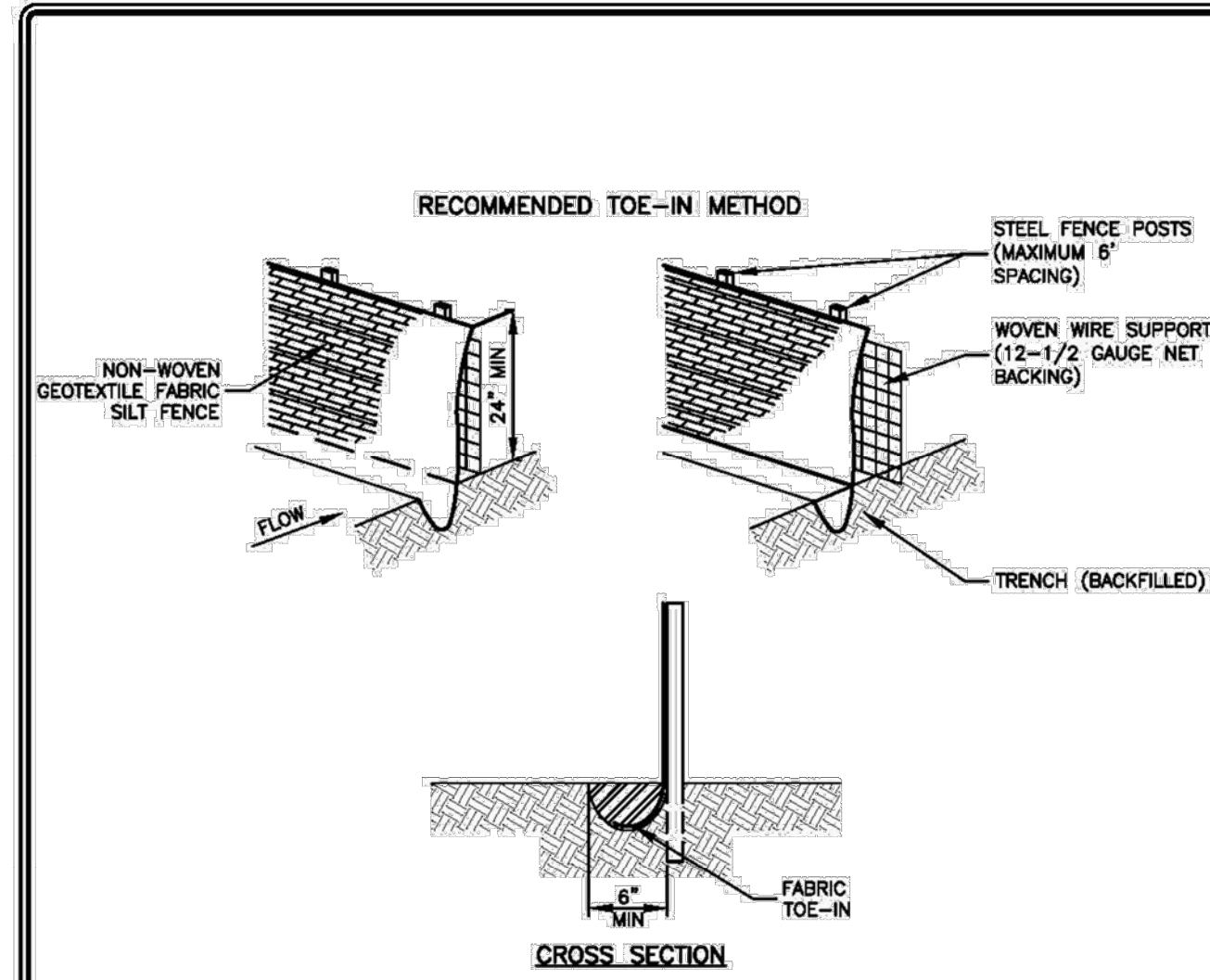

NOTES:

1. STEEL POSTS WHICH SUPPORT THE SILT FENCE SHALL BE INSTALLED ON A SLIGHT ANGLE TOWARD THE ANTICIPATED RUNOFF SOURCE. POST MUST BE EMBEDDED A MIN. OF ONE (1') FOOT.
2. THE TOE OF THE SILT FENCE SHALL BE TRENCHED IN WITH A SPADE OR MECHANICAL TRENCHER, SO THAT THE DOWNSLOPE FACE OF THE TRENCH IS FLAT AND PERPENDICULAR TO THE LINE OF FLOW. WHERE FENCE CANNOT BE TRENCHED IN (E.G. PAVEMENT) WEIGHT FABRIC FLAP WITH WASHED GRAVEL ON UPHILL SIDE TO PREVENT FLOW UNDER FENCE.
3. THE TRENCH MUST BE A MINIMUM OF 6 INCHES DEEP AND 6 INCHES WIDE TO ALLOW FOR THE SILT FENCE FABRIC TO BE LAID IN THE GROUND AND BACKFILLED WITH COMPACTED MATERIAL.
4. SILT FENCE SHALL BE SECURELY FASTENED TO EACH STEEL SUPPORT POST OR TO WOVEN WIRE, WHICH IN TURN IS SECURELY FASTENED TO THE STEEL FENCE POSTS.
5. INSPECTION SHALL BE MADE WEEKLY OR AFTER EACH RAINFALL EVENT AND REPAIR OR REPLACEMENT SHALL BE MADE PROMPTLY AS NEEDED.
6. SILT FENCE SHALL BE REMOVED WHEN THE SITE IS COMPLETELY STABILIZED SO AS NOT TO BLOCK OR IMPEDE STORM FLOW OR DRAINAGE.
7. ACCUMULATED SILT SHALL BE REMOVED WHEN IT REACHES A DEPTH OF 6 INCHES. THE SILT SHALL BE DISPOSED OF IN AN APPROVED SITE AND IN SUCH A MANNER AS TO NOT CONTRIBUTE TO ADDITIONAL SILTATION.
8. SILT FENCE SHALL BE REMOVED AS SOON AS THE SOURCE OF SEDIMENT IS STABILIZED.

RECORD SIGNED COPY ON FILE AT PUBLIC WORKS	CITY OF ROUND ROCK	DRAWING NO. EC-10
APPROVED	SILT FENCE DETAIL	
DATE 09-28-11		
THE ARCHITECT/ENGINEER ASSUMES RESPONSIBILITY FOR THE APPROPRIATE USE OF THIS DETAIL. (NOT TO SCALE)		

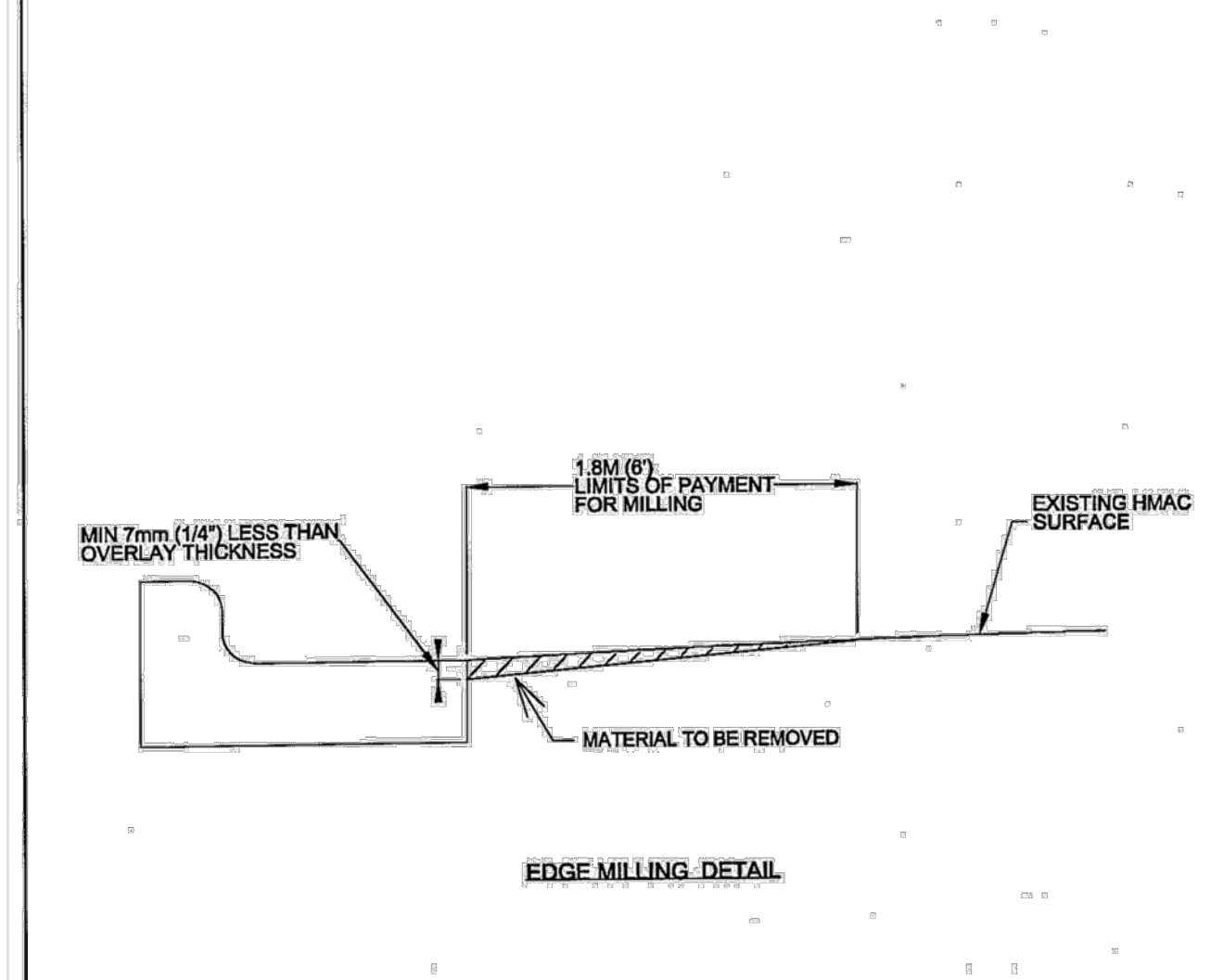

NOTES:

1. MILLING SHALL BE PERFORMED TO A MINIMUM OF 1.8 METERS (6 FEET) FROM THE EDGE OF THE PAVEMENT.
2. MILLING SHALL BE PERFORMED TO A MINIMUM OF 7 MILLIMETERS (1/4 INCH) LESS THAN THE OVERLAY THICKNESS.
3. MILLING SHALL BE PERFORMED TO A MINIMUM OF 6 INCHES DEEP AND 6 INCHES WIDE TO ALLOW FOR THE SILT FENCE FABRIC TO BE LAID IN THE GROUND AND BACKFILLED WITH COMPACTED MATERIAL.
4. MILLING SHALL BE SECURELY FASTENED TO EACH STEEL SUPPORT POST OR TO WOVEN WIRE, WHICH IN TURN IS SECURELY FASTENED TO THE STEEL FENCE POSTS.
5. INSPECTION SHALL BE MADE WEEKLY OR AFTER EACH RAINFALL EVENT AND REPAIR OR REPLACEMENT SHALL BE MADE PROMPTLY AS NEEDED.
6. MILLING SHALL BE REMOVED WHEN THE SITE IS COMPLETELY STABILIZED SO AS NOT TO BLOCK OR IMPEDE STORM FLOW OR DRAINAGE.
7. ACCUMULATED SILT SHALL BE REMOVED WHEN IT REACHES A DEPTH OF 6 INCHES. THE SILT SHALL BE DISPOSED OF IN AN APPROVED SITE AND IN SUCH A MANNER AS TO NOT CONTRIBUTE TO ADDITIONAL SILTATION.
8. MILLING SHALL BE REMOVED AS SOON AS THE SOURCE OF SEDIMENT IS STABILIZED.

CITY OF AUSTIN DEPARTMENT OF PUBLIC WORKS	HMAC PAVEMENT EDGE MILLING DETAIL	STANDARD NO. 315S-1
APPROVED		
DATE 7/1/09	ADOPTED	
THE ARCHITECT/ENGINEER ASSUMES RESPONSIBILITY FOR APPROPRIATE USE OF THIS STANDARD.		

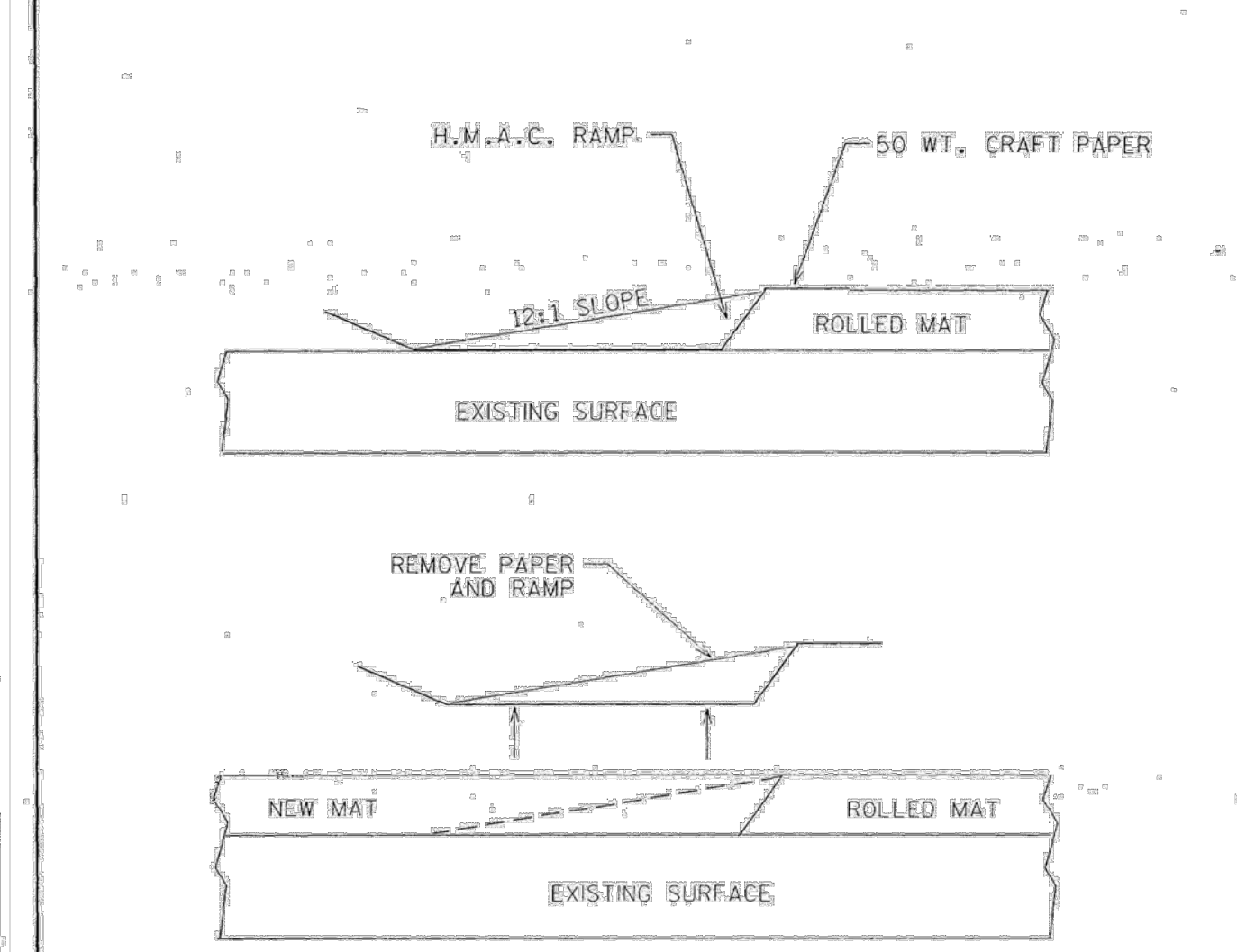

NOTES:

1. WHEN A LIFT OF H.M.A.C. EXCEEDS 25 mm (1"), THIS TRANSVERSE CONSTRUCTION JOINT SHALL BE USED AT THE END OF EACH RUN UNTIL THE NEXT RUN IS PLACED ADJACENT TO IT. THE PAPER AND RAMP SHALL BE REMOVED PRIOR TO PLACING THE NEXT RUN.

CITY OF AUSTIN DEPARTMENT OF PUBLIC WORKS AND TRANSPORTATION	H.M.A.C. TRANSVERSE CONSTRUCTION JOINT	STANDARD NO. 340S-1
APPROVED		
DATE 9/21/99	ADOPTED	
THE ARCHITECT/ENGINEER ASSUMES RESPONSIBILITY FOR APPROPRIATE USE OF THIS STANDARD.		

REV. NO.	REVISION DESCRIPTION	APPROVED BY	DATE

CobbFendley
 TYPE NO. 274 / TBPLS NO. 10046701
 505 EAST HUNTLAND DRIVE, SUITE 100
 AUSTIN, TEXAS 78752
 512.834.9788 | FAX 512.834.9553
 WWW.COBBFENDLEY.COM

STANDARD DETAILS - SHEET 3
 HAIRY MAN 10" WWL RELOCATION
 ROUND ROCK, TEXAS

WILLIAMSON COUNTY
 1848

PROJ. NO. 1703-011-10
 DESIGN: K. VAN HOOSIER
 DRAWN: H. BYRNE
 CHECK: L. PRINCE
 APPR: S. FEES
 DATE: OCTOBER 7, 2020

THESE DESIGN DOCUMENTS ARE NOT TO BE USED FOR CONSTRUCTION PRIOR TO REGULATORY SIGNATURE AND PERMIT.

SHEET
C-503
 8 OF 8

EXHIBIT B

Preliminary Opinion of Probable Construction Costs

EXHIBIT**"B"**

Williamson County 2013 Road Bond
Hairy Man Rd - City of Round Rock
10" WWL Relocation
Engineer's Opinion of Probable Cost - 100%

10/15/2020

Bid Item	Description	Quantity	Unit	Unit Cost	Total Cost
505	Encasement Pipe, 20" Dia., Steel (ASTM A134)	50	LF	\$ 150.00	\$ 7,500.00
506-WW	Drop Manhole w/CIP Base, 5' Dia.	1	EA	\$ 7,000.00	\$ 7,000.00
509	Trench Safety Systems (All Depths)	83	LF	\$ 4.00	\$ 332.00
510-WW	Pipe, 10" Dia. PVC SDR-26 (All Depths)	83	LF	\$ 150.00	\$ 12,505.50
559	Concrete Box Culvert, 4 ft. x 4 ft. for temporary bypass	13	VF	\$ 300.00	\$ 3,900.00
506-6038	TEMP SEDMT CONT FENCE (INSTALL)	165	LF	\$ 1.50	\$ 247.50
506-6039	TEMP SEDMT CONT FENCE (REMOVE)	165	LF	\$ 1.50	\$ 247.50
SP506-BPWW	Temporary Wastewater Bypass Pumping	5	DAY	\$ 2,500.00	\$ 12,500.00
Total					\$ 44,232.50