

**Ramendu Duplex
FINAL PLAT FP2209-001**

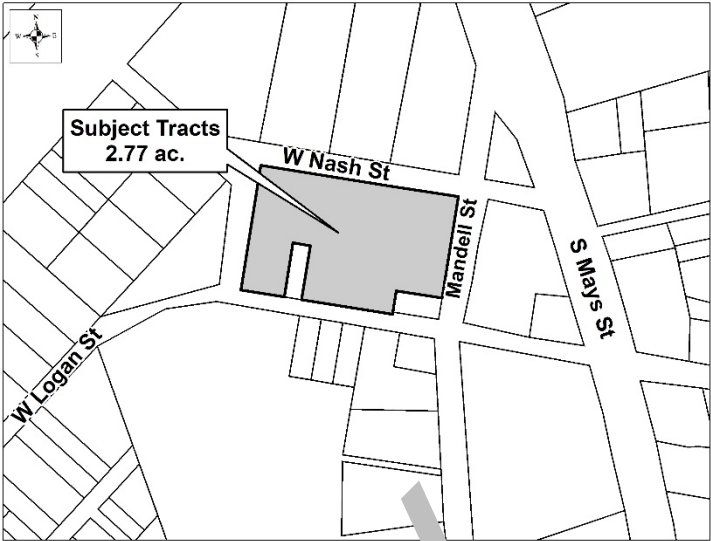

CASE PLANNER: CAITLYN REEVES

REQUEST:

ZONING AT TIME OF APPLICATION:

DESCRIPTION: 2.64 acres out of the

CURRENT USE OF PROPERTY:

COMPREHENSIVE PLAN LAND USE DESIGNATION:

ADJACENT LAND USE:

North:
South:
East:
West:

PROPOSED LAND USE:

<u>PROPOSED LOTS BY TYPE:</u>	<u>NUMBER OF LOTS</u>	<u>ACREAGE</u>
Residential - Single Unit:	0	0
Residential - Multi Unit:	0	0
Office:	0	0
Commercial:	0	0
Industrial:	0	0
Open/Common Space:	0	0
ROW:	0	0
Parkland:	0	0
Other:	0	0

TOTALS: **22** **2.64**

Owner:
Ramendu Duplex at Round Rock, LLC
3016 Paseo de Charros
Cedar Park, TX 78641

Agent:
McIntyre & McIntyre, Inc.
1903 Stonewreath Dr
Round Rock, TX 78681