

University Heights Preliminary Plat  
PRELIM PLAT PP1911-003

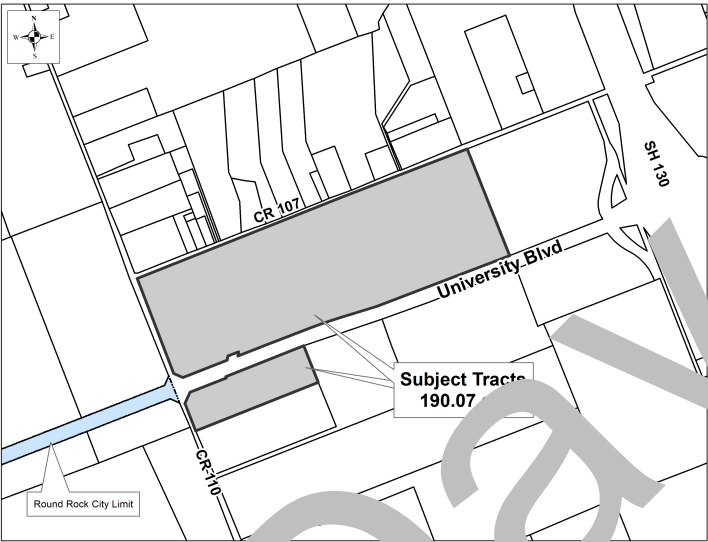

CASE PLANNER: JUAN ENRIQUEZ

REQUEST:

ZONING AT TIME OF APPLICATION:

DESCRIPTION: 190.07 acres out of the Henry M. and S. Survey, Abstract No. 452

CURRENT USE OF PROPERTY:

GENERAL PLAN LAND USE DESIGNATION:

ADJACENT LAND USES:

North:  
South:  
East:  
West:

PROPOSED LAND USE:

<u>PROPOSED LOTS BY TYPE:</u>	<u>NUMBER OF LOTS</u>	<u>ACREAGE</u>
Residential - Single Unit:	0	0
Residential - Multi Unit:	0	0
Office:	0	0
Commercial:	0	0
Industrial:	0	0
Open/Common Space:	0	0
ROW:	0	0
Parkland:	0	0
Other:	0	0
<b>TOTALS:</b>	<b>577</b>	<b>190.07</b>

**Owner:**  
JSL North Investments, LLC  
John S. Lloyd  
4720-4 Rockcliff Road  
Austin, TX 78746

**Agent:**  
Randall Jones & Associates Engineering, Inc.  
Israel Ramirez  
2900 Jazz Street  
Round Rock, TX 78664