

Avery Centre College Park North Phase 2
PRELIM PLAT PP2009-001

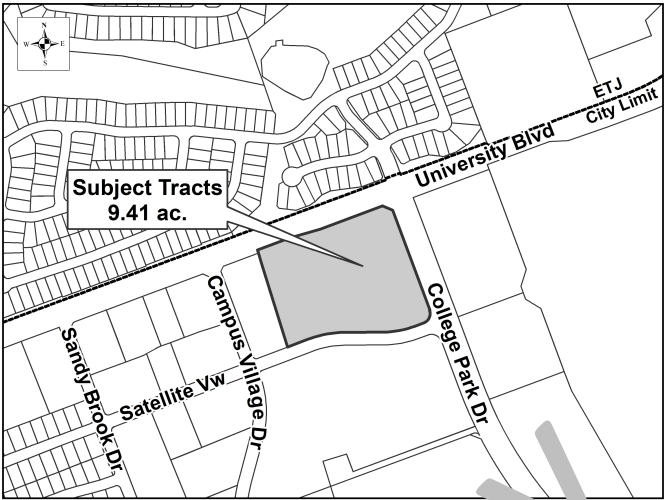

CASE PLANNER: Lee Heckman

REQUEST:

ZONING AT TIME OF APPLICATION:

DESCRIPTION: 0 acres out of the Abel L. Eaves Survey, Abstract No. 215.

CURRENT USE OF PROPERTY:

COMPREHENSIVE PLAN LAND USE DESIGNATION:

ADJACENT LAND USE:

North:
South:
East:
West:

PROPOSED LAND USE:

<u>PROPOSED LOTS BY TYPE:</u>	<u>NUMBER OF LOTS</u>	<u>ACREAGE</u>
Residential - Single Unit:	0	0
Residential - Multi Unit:	0	0
Office:	0	0
Commercial:	0	0
Industrial:	0	0
Open/Common Space:	0	0
ROW:	0	0
Parkland:	0	0
Other:	0	0
TOTALS:	0	0

Owner:
Avery Centre Development, Inc.
John S. Avery
400 E. Main St.
Round Rock, TX 78664

Agent:
Bleyl Engineering
Hector Vargas
12007
Austin, TX 78727